

Precision rail guides

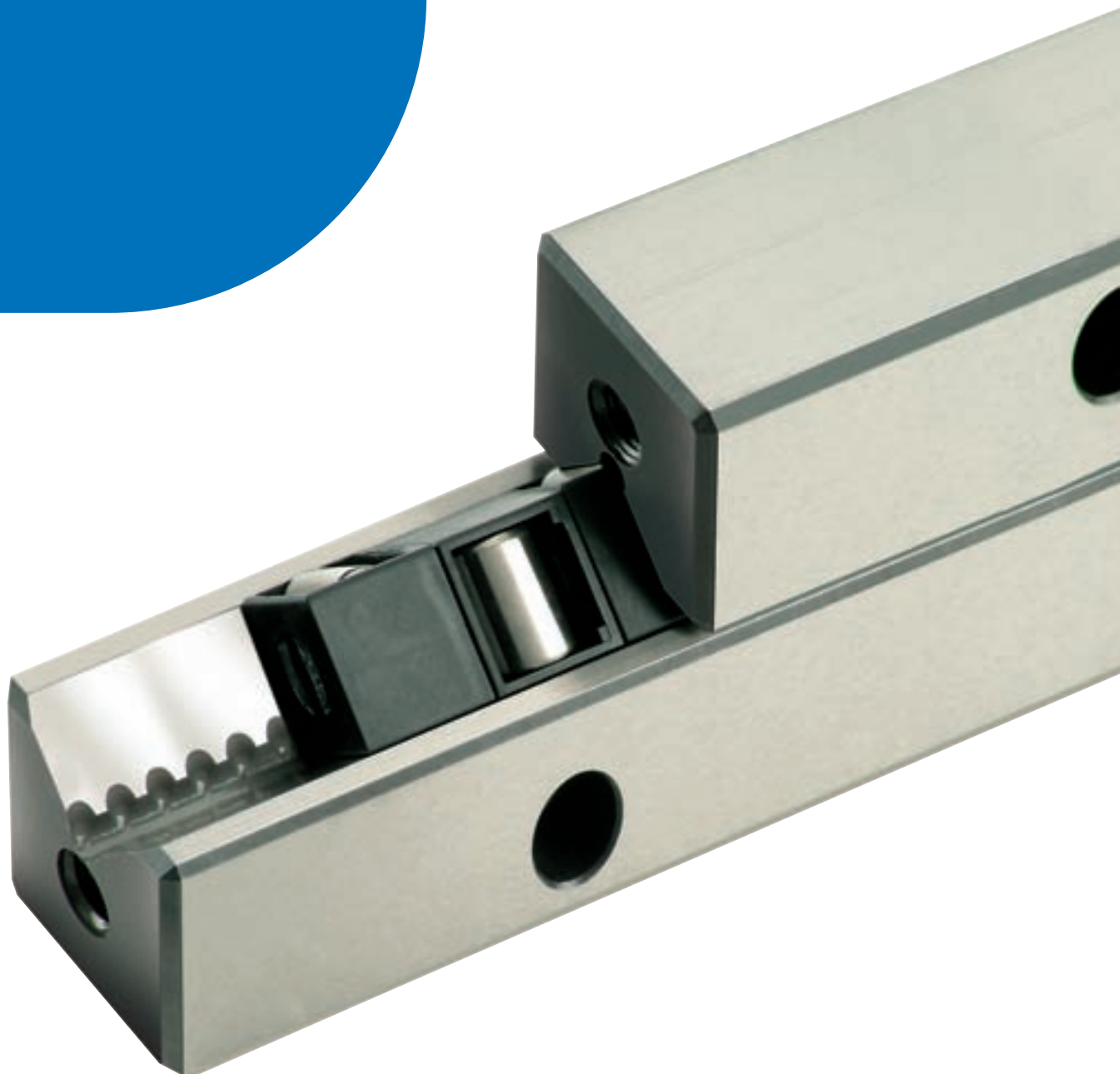



The SKF® brand now stands for more than ever before, and means more to you as a valued customer.

While SKF maintains its leadership as the hallmark of quality bearings throughout the world, new dimensions in technical advances, product support and services have evolved SKF into a truly solutions-oriented supplier, creating greater value for customers.

These solutions encompass ways to bring greater productivity to customers, not only with breakthrough application-specific products, but also through leading-edge design simulation tools and consultancy services, plant asset efficiency maintenance programmes, and the industry's most advanced supply management techniques.

The SKF brand still stands for the very best in rolling bearings, but it now stands for much more.

SKF – the knowledge engineering company

Content

General information

- 3 Introduction
- 4 Produkt overview
- 4 Modular Range rail guides
- 8 Other products

Technical data

- 9 Precision of rail guides
- 9 Raceway accuracy
- 9 Dimensional accuracy
- 10 Grading
- 10 Tolerance of distance between attachment holes
- 10 Marking of matches sets
- 11 Accuracy of adjacent components
- 11 Selection of rail guides

SKF precision rail guides in kit packaging

- 12 Rail guides in kit packaging
- 12 Advantages of rail guide kits
- 12 LWR rail guides in kit packaging - table
- 13 LWRE rail guides in kit packaging - table
- 13 LWRE ACS rail guides in kit packaging (supplied to order) - table

LWR rail guides

- 14 LWR rail guides with crossed roller assemblies
- 14 LWR rail guides with ball assembly
- 15 Ball and crosses roller assemblies
- 18 Accessories for LWR rail guides

LWRE rail guides

- 20 LWRE rail guides
- 21 Crossed roller assemblies
- 21 Special attachment screws
- 22 LWRE 3 - LWRE 9 / LWRE 2211
- 24 Accessories for LWRE rail guides
- 25 LWRE ACS rail guides with non-slip cage (Anti Creep System)
- 26 Accessories for LWRE ACS rail guides

LWRM/LWRV rail guides

- 29 LWRM/LWRPV rail guides
- 30 LWRM/LWRV 6 and LWRM/LWRV 9
- 32 Accessories for LWRPM/LWRPV rail guides

LWRPM/LWRPV rail guides

- 33 LWM/LWV rail guides
- 34 LWRPM/LWRPV 3 - LWRPM/LWRPV 9
- 36 Accessories for LWRPM/LWRPV rail guides

LWM/LWV rail guides

- 37 LWRPM/LWRPV rail guides
- 38 LWM/LWV 3015 - LWM/LWV 8050
- 40 Accessories for LWM/LWV rail guides

LWJ/LWS flat rail guides

- 41 LWJ/LWS flat rail guides

LZM miniature slide

- 42 LZM miniature slide

Standard slides

- 44 Design and characteristic features
- 45 Technical data
- 46 GCL - Drill hole pattern in top plate
- 47 GCL - Drill hole pattern in base plate

Introduction

As the world's leading rolling bearing manufacturer, SKF supplies practically every type of bearing for rotational and linear motion.

SKF is therefore in a position to meet almost any customer requirement both technically and economically.

This catalogue covers the SKF range of precision rail guides and accessories.

SKF precision rail guides are highly accurate products for linear motion and are therefore ideally suited for use in a wide variety of machine tools, machining centres, handling systems and special machinery as well as measuring and testing equipment.

The "Modular Range" has introduced a new concept to the market, ensuring the internal interchangeability of all well-known guidance systems including the high capacity LWRE-type rail guides. This matrix range of rail guide modules permits the individual selection of rails and rolling elements.

SKF precision rail guides are available in many different designs, sizes and standard lengths, incorporating ball, roller or needle roller assemblies and slide coating. They are supplied with the required accessories for attachment and sealing.

The use of SKF precision rail guides facilitates the construction of economical, clearance-free linear guides of practically any type and length, according to the building block principle. The characteristics of the guides include:

- a constant, high degree of running accuracy
- low-friction, stick-slip free operation
- high speed of travel
- low heat generation
- low wear and high reliability
- high stiffness
- excellent load carrying capacity

If there is a danger of cage-creep (in particular when the guide is mounted vertically), precision rail guides of type LWRE-ACS (Anti-Creep System) are an obvious choice, as they will eliminate this problem.

For applications that are characterised by high accelerations or short strokes of high frequency, SKF rail guides with dry sliding coating are recommended.

These rail guides are also suitable for machine tool applications where the good damping properties of the guides are of greater importance than the lower friction of the rolling element rail guides. For those applications where rail guides are unsuitable, for instance because of their limited travel, SKF can supply alternative forms of linear guidance systems.

All fast-selling precision rail guides are also available in convenient kit packaging. This ensures complete delivery of all single components including end pieces and screws. If you would like further details, please contact the SKF application engineering department. We will be pleased to provide the required information without obligation and at no cost, or to prepare a technical proposal.

This catalogue brings together all the basic data which we consider to be of interest. For further specialised advice please contact your nearest SKF sales office.

Product overview

SKF modular range rail guides



LWRPM/PV

LWRM/V

LWRE

LWRE ACS

LWR
with ball assembly

LWR
with roller assembly

Non-slip cage
of LWRE ACS



SKF modular range rail guides

The SKF modular range consists of a matrix range of rail guide modules that enables individual permutations of rails and rolling element assemblies. Different requirements for the guides do not call for changes in the design or mechanical environment. The choice of appropriate rail guides is determined solely by the mechanical conditions under which the guide system is to operate. These operating requirements are covered by six different models (Fig. 1) that may be defined as rail guides with:

- crossed roller assemblies of the standard LWR series
- ball assemblies of the LWRB series
- crossed roller assemblies of the optimised LWRE series
- crossed roller assemblies with non-slip cage to prevent cage-creep of the LWRE ACS series
- needle roller assemblies of the LWRM/LWRV series and
- slide coating of the LWRPM/LWRPV series

The blue shaded areas in the chart indicate the sizes included in the Modular Range. Experience has shown that some 80 % of applications can be covered by these (Fig. 2).

Contrary to the current lack of uniformity within the market, the standard, interchangeable guidance systems of the Modular Range cover almost the entire spectrum of rail

guide applications. The choice of a specific rolling element or, for extreme conditions, of a slide coating, is determined only by the actual operating conditions (Fig. 5). Generally, any rail guide can be operated in the 'clamped' or 'floating' mode. The design of the rail guides does not impose any special space requirements.

Fig. 2

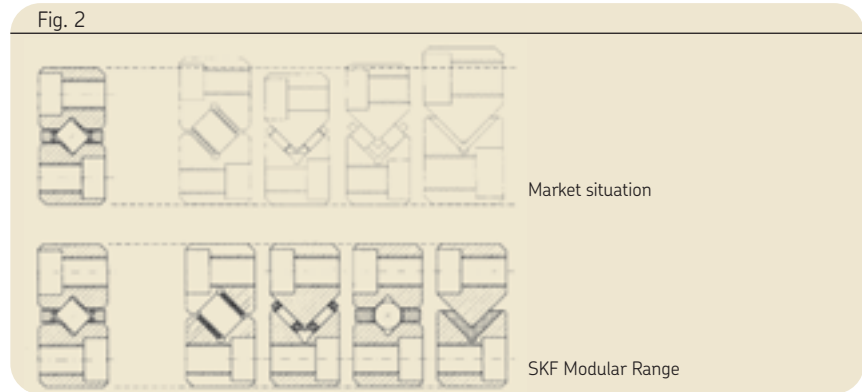

Fig. 1

| | | A x B | | | | | | | | | | |
|----------|------|---------|--------|--------|---------|---------|---------|---------|---------|---------|---------|----------|
| | | 8.5 x 4 | 12 x 6 | 18 x 8 | 22 x 11 | 25 x 12 | 31 x 15 | 44 x 22 | 58 x 28 | 71 x 36 | 83 x 40 | 110 x 55 |
| Type | Size | 1 | 2 | 3 | 2211 | 4 | 6 | 9 | 12 | 15 | 18 | 24 |
| LWR | | - | - | X | - | - | X | X | 0 | 0 | 0 | 0 |
| LWRE | | - | - | X | 0 | X | X | X | - | - | - | - |
| LWRE ACS | | - | - | X | 0 | 0 | 0 | 0 | - | - | - | - |
| LWRV | | - | - | - | - | - | 0 | 0 | 0 | 0 | - | - |
| LWRPV | | - | - | 0 | - | - | 0 | 0 | 0 | 0 | - | - |
| LWRB | | X | X | - | - | - | - | - | - | - | - | - |

= Modular Range

X = available ex-stock in standard lengths
 0 = available to order
 - = not available

Increased performance achievable without design modification

The Modular System is based on the well-proven LWR design which covers a wide range of applications. The new optimised LWRE series offers either doubled stiffness and a load carrying capacity increased by a factor of five or, alternatively, for a given load carrying capacity, a 50 % reduction in bearing size compared with the standard LWR design (Fig. 3).

Fig. 3

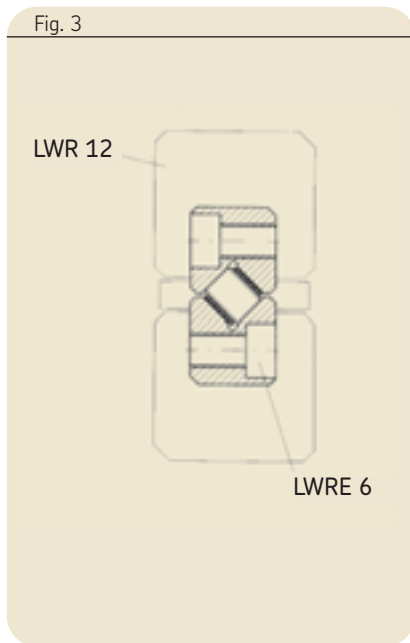

Complete range

In order to further simplify the application of Modular Range rail guides, all guides within a given size range have the same external dimensions and thus fit the space requirements of most commercially available rail guides. This results in a very wide choice in terms of load carrying capacity, stiffness and operating characteristics.

From the economical point of view, the use of the optimised LWRE series offers a double advantage.

Firstly (although the initial cost is slightly higher) the range of application is extended significantly as regards stiffness and load carrying ca-

capacity. It thus offers a far better price/performance ratio. Secondly, the replacement of other rail guides, including those supplied by other manufacturers and already installed, can be carried out with ease and in a minimum of time.

Above all, where the user needs to increase machine performance, a unit with a higher load rating can be fitted. In-situ replacement is made easier by the fact that no new attachment holes or fixing devices are required when using rail guides of the Modular Range. An additional advantage is the worldwide availability through distributors, simply by quoting the appropriate catalogue number. The internal design of the LWRE series ensures increased operational life through even distribution of load. This results from the optimisation of the cross-section which permits the use of larger rolling elements. The new design leads to a significant improvement in the roller/raceway contact performance. An important additional benefit is the introduction of a practically maintenance-free cage made of POM that matches the stringent demands for long operational life of the rolling elements and maintains its dimensional stability up to +80 °C. The individual rollers are well covered and the space between the rails is almost filled, thus providing good protection against contamination. A special characteristic of the LWAKE 3, 6 and 9 cages is that they consist of 'snap-on' elements and can be fitted together to the required length (Fig. 4). Conventional crossed roller cages have their rollers arranged alternately evenly spaced, so that only half the rollers in a preloaded guide are load-bearing while the remainder act as idlers. In the new LWRE cage these essentially unused rollers can be partially turned in the direction of the load. For this purpose each individual cage segment is designed to

Fig. 4

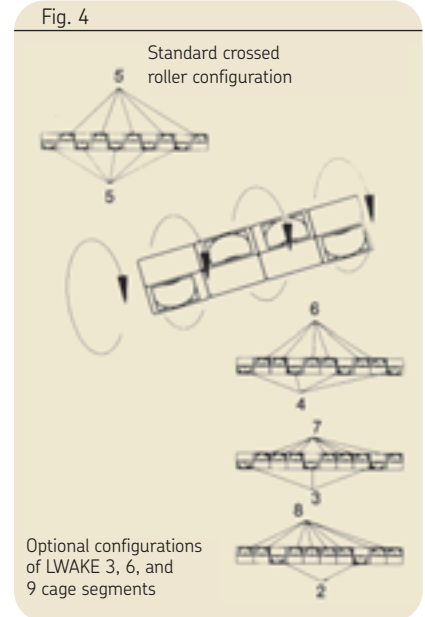

be turned through 90° about the longitudinal axis. These are manual adjustments and no special instructions are required when ordering from the catalogue.

LWAKE 4 crossed roller cages consist of roller segments that are assembled according to the length specified by the customer.

Fig. 5

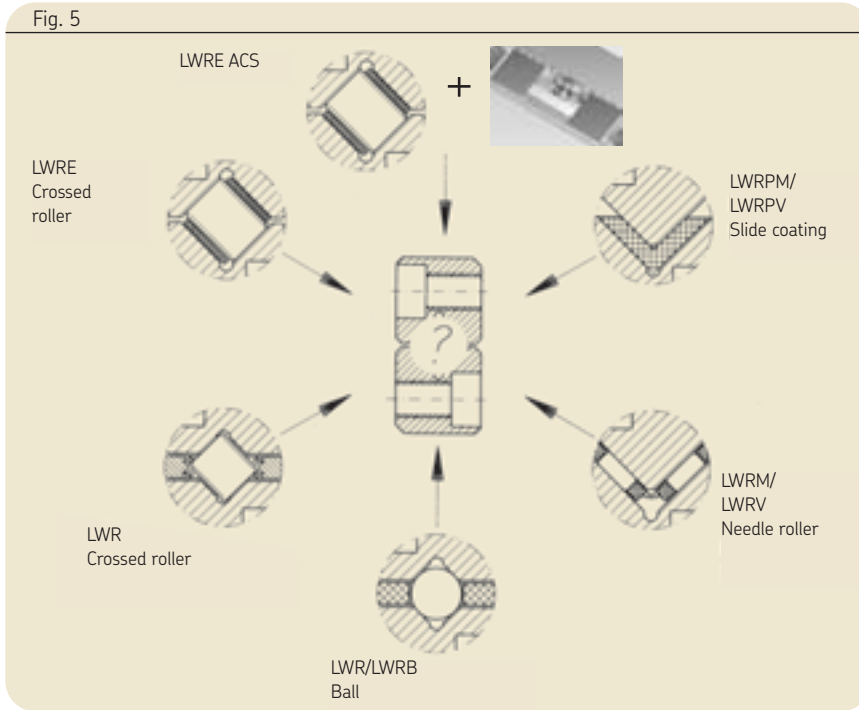

LWR/LWRB series

This basic series of the Modular Range covers a wide variety of rail guide applications for limited travel. Where low friction is essential, ball cage assemblies are recommended. If, on the other hand, high load carrying capacity is the chief requirement, robust crossed roller assemblies are to be preferred. The LWR series is manufactured in nine sizes based on rolling element dimensions.

LWRE series

For a given load carrying capacity, the dimensions of the LWRE series are significantly less than those of the corresponding member of the LWR series. Thus, for instance, an LWRE 6 guide with a cage length of 100 mm has a greater load carrying capacity than a standard LWR 12. The LWR 12 measures 58 x 28 mm whereas the LWRE 6 measures only 31 x 15 mm (Fig. 1).

LWRE ACS series

All rails of the LWRE series are also available with ACS, a special system to prevent “cage-creep”. These rails are used where cage-creep occurs due to high acceleration, uneven preloading or load distribution as well as jerky running or direction-dependent speeds of travel.

LWRM/LWRV series

These guides are used principally where high load carrying capacity is called for in combination with high stiffness, for instance on grinding machines. This series is fitted with needle roller and cage assemblies consisting of two rows of needle rollers at right angles to each other.

LWRPM/LWRPV series

Where extremely short strokes of high frequency occur, this special series with slide coating is an essential alternative to those with rolling element assemblies. In the case of balls or rollers subjected to high transverse acceleration, pitting of the tracks

may occur as a result of the unfavourable tribological conditions. Sliding rail guides are preferred in such circumstances.

The coating material is based on PTFE and is bonded on to the unhardened LWRPM rail and then ground to the correct dimension.

This wear-resistant material combination is characterised by its stick-slip-free, vibration-damping running properties, at the same time offering excellent stiffness and emergency running properties. These guide rails are largely insensitive to contamination, coolants and lubricants.

Materials and precision

The rails of the Modular Range guides are manufactured from tool steel 1.2842 (90 MnCrV 8) with a hardness of between 58 and 62 HRC. If required by the application, the rails can also be supplied in special stainless or acid-resistant steel, e.g. 1.4112 or 1.4034 or equivalent (depending on the profile). All rolling elements are made from carbon chromium steel 1.3505 (100 Cr 6) with a hardness of between 58 and 64 HRC. The parallelism of the raceways is divided into three classes. Class P10, with a maximum deviation of 10 µm per 1 000 mm length, meets most of the demands for normal machinery. Where greater precision is required, tolerance classes P5 and P2 are also available.

The assortment is complemented by various accessories specially designed for the Modular Range of rail guides. These include end pieces with or without wipers as well as special attachment screws.

Other products

In addition to the Modular Range, the selection of SKF products also includes a wide variety of rail guides and rolling elements.

LWM/LWV rail guides

(see table on pages 38-40)

LWM/LWV rail guides differ from the LWRM/LWRV guides of the Modular Range only in their external dimensions. Their internal geometry is identical and the same needle roller assemblies are therefore used.

In contrast to LWRM/LWRV (two series), the LWM/LWV guides comprise 6 series up to a size of A x B = 80 mm x 50 mm. LWM/LWV rail guides are supplied as standard with holes of type 15, namely through holes with counterbore. If for design reasons it is necessary to screw both rails from the same side, then one of the rails should have holes of type 13, i.e. with thread insert.

LWML rail guides

(no table)

The LWML rail guide consists of a modified LWM rail guide with the addition of an adjustment wedge. Used in conjunction with an LWV guide and a needle roller assembly this provides an adjustable guide unit. The inclination of the wedge surface is 1,5 % so that a displacement of the wedge by 1 mm brings about a 15 µm alteration in the height.

LWML rail guides are supplied as standard with holes of type 15, i.e. through holes with counterbore. If required holes of type 13, i.e. with thread insert, are also available.

LWML rail guides can be supplied to tolerance classes P10 and P5. These guides, as well as the appropriate needle roller assemblies and end pieces, are made to order.

Because of the many permutations available, each part of an LWML/LWV rail guide must be ordered separately, e.g.:

1 rail LWML 55200400
1 rail LWM 40200400
2 rails LWV 40200400
2 end pieces LWEML 4020
2 end pieces LWEM 4020

It should also be stated whether the holes should comprise right-hand or left-hand threads.

LWN/LWO rail guides

(no table)

LWN/LWO rail guides differ from the LWM/LWV rail guides only in height, width and attachment holes. The internal geometry is identical to that of the LWM/LWV guides, i.e. they have the same load rating. LWN/LWO rail guides are available in tolerance classes P10, P5 and P2 to order.

LWW/LWZ flat rail guides

(no table)

LWW/LWZ flat rail guides are used in conjunction with LWR rail guides for incorporation in floating slides. LWW/LWZ flat rail guides and the appropriate rolling element assemblies and end pieces are available to order.

LWJ/LWS flat rail guides

(no table)

LWJ/LWS flat rail guides are used in conjunction with LWRM/LWRV, LWM/LWV or LWN/LWO rail guides as non-locating linear guides. They are incorporated in floating slides. LWJ/LWS flat rail guides as well as the appropriate rolling element assemblies and end pieces are available to order.

Special rail guides and recirculating roller assemblies

In addition to the standard rail guides included in this catalogue, SKF also manufactures flat rail guides with recirculating roller assemblies as well as special rail guides to customer drawings for such applications as machine tools, handling systems

and robotics. Further information on these special versions and their availability will be supplied on request.

Technical data

Precision of rail guides

All SKF precision rail guides, regardless of type, are manufactured to the same tolerances indicated below.

Raceway accuracy

In order to meet the different requirements regarding the precision of linear bearing arrangements, the rails are produced in three different tolerance classes. These are classified according to the parallelism between the raceways and the support surfaces A and B (Fig. 6).

P10

Tolerance class normal. This meets the requirements of general engineering applications. The deviation from parallelism for a 1 000 mm long rail is approximately 10 µm. See also adjacent table 1.

P5

This satisfies the demands normally made on the running accuracy for machine tool applications. The deviation from parallelism for a 1 000 mm long rail is 5 µm maximum. See also adjacent table 1.

P2

Accuracy for the most exacting demands. Rails made to this tolerance class should only be used when the associated components are made to a correspondingly high degree of precision. Rails to tolerance class P2 will be manufactured by SKF to special order. See also table 1.

If no mention is made of the requisite accuracy on the order, rails with normal P10 tolerances will be supplied.

Dimensional accuracy

SKF precision rail guides with limited travel are produced to the following tolerances (Figs. 7 and 8):

Width A: 0/-0,3mm
 Abutment height
 $T = B1 + B2 \pm 0,02 \text{ mm}$
 Rail height B: 0/-0,2 mm
 Rail length L: $L \leq 300 \pm 0,3$
 $L > 300 \pm 0,001 \cdot L [\text{mm}]$

For rails composed of two or more sections the tolerance for the total length is $\pm 2 \text{ mm}$.

SKF precision rail guides for recirculating roller assemblies are produced to the following tolerances:

Width A: 0/+0,1 mm
 Height A: 0/+0,1 mm
 Length L: $L \leq 300 \pm 0,3$
 $L > 300 \pm 0,001 \cdot L [\text{mm}]$

Fig. 6

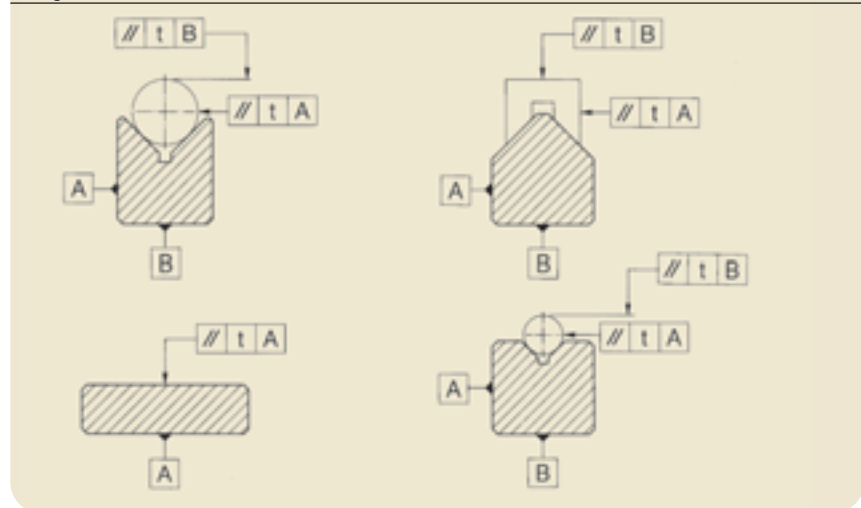

Table 1

Permissible deviation in parallelism between reference planes A and B

| Rail length from | to | Tolerance class | | |
|---------------------|--------|-----------------|----|----|
| | | P10 | P5 | P2 |
| mm | | µm | | |
| | 100 | 2 | 1 | 1 |
| 100 | 200 | 3 | 2 | 1 |
| 200 | 300 | 4 | 2 | 1 |
| 300 | 400 | 5 | 2 | 2 |
| 400 | 500 | 6 | 3 | 2 |
| 500 | 600 | 6 | 3 | 2 |
| 600 | 700 | 7 | 4 | 2 |
| 700 | 800 | 8 | 4 | 2 |
| 800 | 900 | 8 | 5 | 2 |
| 900 | 1 000 | 9 | 5 | 2 |
| 1 000 | 1 200 | 10 | 6 | 3 |
| 1 200 | 1 400 | 11 | 6 | 3 |
| 1 400 | 1 600* | 12 | 7 | 3 |

* Rail length > 1 600 mm, please contact SKF

Grading

Precision rail guides with limited travel are generally mounted in pairs. In order to obtain the same assembly height T (Fig. 7), the rails are graded and supplied in pairs.

This ensures that any two similar rail guides in a system will have the same height.

If two or more rolling element assemblies are to be mounted immediately behind each other in a rail guide, the rolling elements must have the same tolerance grade. On request, graded rolling element assemblies can be supplied.

Rails of the same profile for recirculating roller assemblies, which are to be mounted immediately adjacent to each other or immediately behind each other should be ordered in graded condition. Depending on their type, they will be graded in height or in height and width and delivered as a single package.

Rail guide sets are always matched so that it is not necessary to request this when ordering.

Tolerance of distance between attachment holes

The maximum deviation in the distance between the attachment holes measured from centre to centre is $\pm 0,8\%$ of the rail length L for one-piece rails (Fig. 8). Where the rail consists of several sections, the tolerance is also $\pm 0,8\%$, related to the length of the longest section. Rails having tighter tolerances for the distance between the holes can be supplied on request.

Marking of matched sets

Matched components are marked with consecutive numbers as indicated in Fig. 8a.

Fig. 7

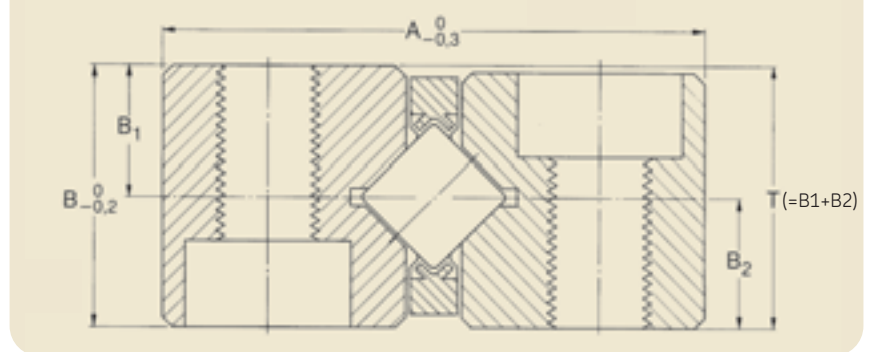

Fig. 8

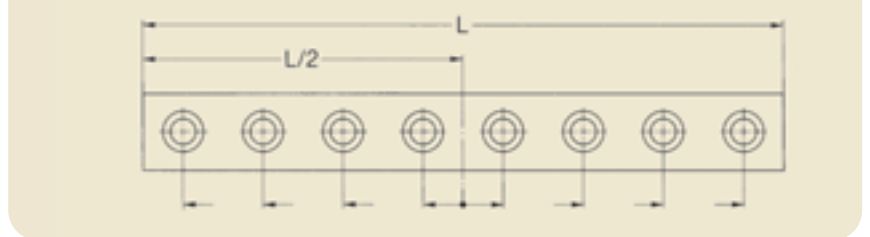

Fig. 8a



Accuracy of adjacent components

An important criterion for the correct performance of a rail guide system is the accuracy of the associated components. The higher the demands for accuracy of guidance and for smooth, easy operation, the greater the attention which must be paid to the accuracy of form and position of the associated components. Generally the same accuracy requirements should be applied to these components as to the rail guides themselves. The adjacent table shows the values, for each tolerance class, of the surface roughness, perpendicularity and parallelism of the adjacent components.

To assure an even load distribution over the roller length, the maximum difference in height of the supports for a rail guide should not exceed

$$\Delta h = 0,1 \cdot B_1$$

where

Δh = maximum height deviation, μm

B_1 = mean distance between two rail guides, mm

To obtain good support for the rails on the associated components, the attachment holes should be carefully deburred (Figs. 9 and 10).

Selection of rail guides

When selecting a rail guide, the length of travel, load carrying capacity, requisite life and stiffness are the most decisive factors. Other important parameters include the requisite speed of travel, lubrication, operating temperatures, ease of movement, environmental influences and certain design constraints, for instance whether "clamped" or "floating" guidance is required. If further information is needed, please contact SKF.

The selection of the size and length of the rolling element assemblies is mainly determined by the required

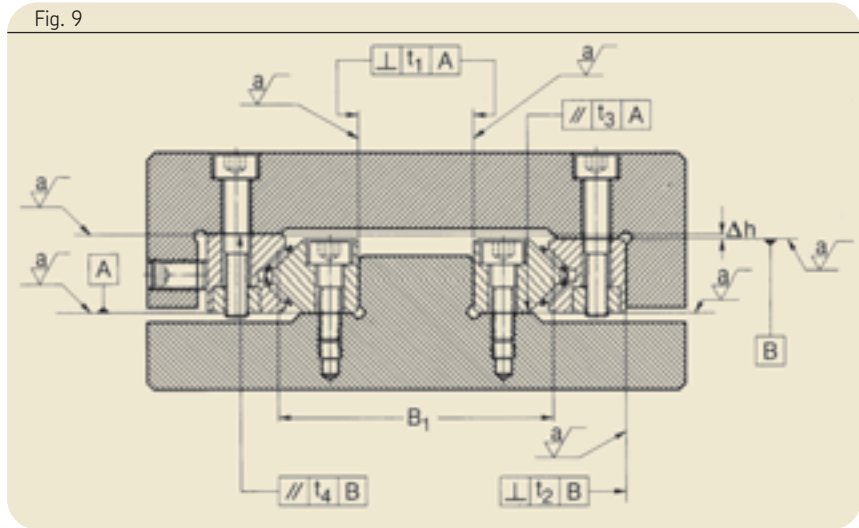

Fig. 10

Accuracy of form of support surfaces

| Characteristic | Symbol for | | Dimensions | Permissible deviation of form | | |
|------------------|---------------------|-------------------|-------------------------|---|-----|-------|
| | Charac- teristic | Tolerance zone | | Tolerance class | | |
| | | | | P10 | P5 | P2 |
| Roughness R_a | $\sqrt{\quad}$ | a | μm | 1,6 | 0,8 | 0,2 |
| Perpendicularity | \perp | t_1/t_2 | $\mu\text{m}/\text{mm}$ | 0,3 | 0,3 | 0,3 |
| Parallelism | // | t_3/T_4 | μm | depending on the guide length L (mm) | | |
| | | | | 3 | 2 | 1 |
| | | | | 6 | 4 | 2 |
| | | | | 10 | 6 | 3 |
| | | | | | | 1 000 |

load carrying capacity, life and stiffness.

For light, centrally acting loads and moderate demands for speed of travel, it is possible to use practically all the types of guides listed in this catalogue. However, technical and economic reasons often dictate the choice of the most appropriate model for a given application.

The length of a rail guide and of the individual rails is mainly determined by the travel as well as the length of the rolling element assemblies, which depends on the requisite load carrying capacity and life.

The following relationships serve as guidelines for determining the

length of rail guides and rolling element assemblies:

For a given stroke:
Cage length = stroke, at least

For a given cage length:
Rail length = cage length
+ 0,5 x stroke

For a given rail length and stroke, the cage length is obtained from:
Cage length = Rail length
- 0,5 x stroke

SKF precision rail guides in kit packaging

Rail guides in kit packaging

Kit packaging is a new service offered by SKF. Each kit consists of a four-piece rail guide set, 2 cages and 8 end pieces.

Advantages of rail guide kits

- all required components are supplied in ready-to-mount sets and can be ordered via one single order number
- for enhanced ease of mounting, all parts can now be supplied directly to the machine on site
- cage length easily adjustable
- environmentally compatible packaging that can be returned free of charge and directed to the recycling process
- most kits available ex stock
- also available with ACS for the effective prevention of cage-creep



Certified in accordance with ISO 14001, SKF Linear Motion and the entire SKF Group attach great importance to environmental protection. Hence as a matter of course, SKF

kit packagings can be returned free of charge and are directed to the recycling process. This makes them both a convenient and an environmentally-friendly packaging solution.

LWR rail guides in kit packaging

| Designation | Load ratings | | Stroke | | Type of rail 4 pieces | Type of cage 2 pieces |
|--------------------------------|--------------|-------------------------|--------|------|--------------------------|--------------------------|
| | dyn. C | stat. C ₀ | min. | max. | | |
| | | N | | mm | | |
| LWR 3050 Kit | 999 | 1 120 | 26 | 33 | LWR 3050 | LWAK 3x7 |
| LWR 3075 Kit | 1 422 | 1 760 | 36 | 50 | LWR 3075 | LWAK 3x11 |
| LWR 3100 Kit | 1 811 | 2 400 | 46 | 67 | LWR 3100 | LWAK 3x15 |
| LWR 3125 Kit | 2 088 | 2 880 | 66 | 83 | LWR 3125 | LWAK 3x18 |
| LWR 3150 Kit | 2 442 | 3 520 | 76 | 100 | LWR 3150 | LWAK 3x22 |
| LWR 3175 Kit | 2 781 | 4 160 | 86 | 117 | LWR 3175 | LWAK 3x26 |
| LWR 3200 Kit | 3 110 | 4 800 | 96 | 133 | LWR 3200 | LWAK 3x30 |
| including 8 end pieces LWERA 3 | | | | | | |
| LWR 6100 Kit | 4 915 | 5 440 | 50 | 67 | LWR 6100 | LWAL 6x8 |
| LWR 6150 Kit | 6 744 | 8 160 | 78 | 100 | LWR 6150 | LWAL 6x12 |
| LWR 6200 Kit | 8 441 | 10 880 | 106 | 133 | LWR 6200 | LWAL 6x16 |
| LWR 6250 Kit | 10 045 | 13 600 | 134 | 167 | LWR 6250 | LWAL 6x20 |
| LWR 6300 Kit | 11 955 | 17 000 | 144 | 200 | LWR 6300 | LWAL 6x25 |
| LWR 6350 Kit | 13 422 | 19 720 | 172 | 233 | LWR 6350 | LWAL 6x29 |
| LWR 6400 Kit | 14 846 | 22 440 | 200 | 267 | LWR 6400 | LWAL 6x33 |
| including 8 end pieces LWERA 6 | | | | | | |

LWRE rail guides in kit packaging

| Designation | Load ratings | | Stroke | | Type of rail 4 pieces | Type of cage 2 pieces |
|--------------------------------|--------------|-------------------------|--------|------|--------------------------|--------------------------|
| | dyn. C | stat. C ₀ | min. | max. | | |
| | N | | mm | | | |
| LWRE 3050 Kit | 4 230 | 5 100 | 25 | 33 | LWRE 3050 | LWAKE 3x6 |
| LWRE 3075 Kit | 5 803 | 7 650 | 38 | 50 | LWRE 3075 | LWAKE 3x9 |
| LWRE 3100 Kit | 7 263 | 10 200 | 50 | 67 | LWRE 3100 | LWAKE 3x12 |
| LWRE 3125 Kit | 8 644 | 12 750 | 63 | 83 | LWRE 3125 | LWAKE 3x15 |
| LWRE 3150 Kit | 9 964 | 15 300 | 75 | 100 | LWRE 3150 | LWAKE 3x18 |
| LWRE 3175 Kit | 11 238 | 17 850 | 88 | 117 | LWRE 3175 | LWAKE 3x21 |
| LWRE 3200 Kit | 12 471 | 20 400 | 100 | 133 | LWRE 3200 | LWAKE 3x24 |
| including 8 end pieces LWERE 3 | | | | | | |
| LWRE 4100 Kit | 17 300 | 20 800 | 39 | 67 | LWRE 4100 | LWAKE 4x10 |
| LWRE 4150 Kit | 23 735 | 31 200 | 62 | 100 | LWRE 4150 | LWAKE 4x15 |
| LWRE 4200 Kit | 28 541 | 39 520 | 95 | 133 | LWRE 4200 | LWAKE 4x19 |
| LWRE 4250 Kit | 34 246 | 49 920 | 118 | 167 | LWRE 4250 | LWAKE 4x24 |
| LWRE 4300 Kit | 38 622 | 58 240 | 152 | 200 | LWRE 4300 | LWAKE 4x28 |
| LWRE 4350 Kit | 43 902 | 68 640 | 169 | 233 | LWRE 4350 | LWAKE 4x33 |
| LWRE 4400 Kit | 49 009 | 79 040 | 192 | 267 | LWRE 4400 | LWAKE 4x38 |
| including 8 end pieces LWERE 3 | | | | | | |
| LWRE 6100 Kit | 25 743 | 27 300 | 46 | 67 | LWRE 6100 | LWAKE 6x7 |
| LWRE 6150 Kit | 34 000 | 39 000 | 80 | 100 | LWRE 6150 | LWAKE 6x10 |
| LWRE 6200 Kit | 44 204 | 54 600 | 92 | 133 | LWRE 6200 | LWAKE 6x14 |
| LWRE 6250 Kit | 51 431 | 66 300 | 126 | 167 | LWRE 6250 | LWAKE 6x17 |
| LWRE 6300 Kit | 58 382 | 78 000 | 160 | 200 | LWRE 6300 | LWAKE 6x20 |
| LWRE 6350 Kit | 67 304 | 93 600 | 172 | 233 | LWRE 6350 | LWAKE 6x24 |
| LWRE 6400 Kit | 73 781 | 10 5300 | 206 | 267 | LWRE 6400 | LWAKE 6x27 |
| including 8 end pieces LWERE 6 | | | | | | |

LWRE ACS rail guides in kit packaging (supplied to order)

| Designation | Load ratings | | Stroke | | Type of rail 4 pieces | Type of cage 2 pieces |
|--------------------------------|--------------|-------------------------|--------|------|--------------------------|--------------------------|
| | dyn. C | stat. C ₀ | min. | max. | | |
| | N | | mm | | | |
| LWRE 3050 ACS - Kit | 3 465 | 4 250 | 20 | 33 | LWRE 3050 ACS | LWAKE 3 x 5 ACS |
| LWRE 3075 ACS - Kit | 5 294 | 6 800 | 30 | 50 | LWRE 3075 ACS | LWAKE 3 x 6 ACS |
| LWRE 3100 ACS - Kit | 6 300 | 8 500 | 45 | 67 | LWRE 3100 ACS | LWAKE 3 x 10 ACS |
| LWRE 3125 ACS - Kit | 7 731 | 11 050 | 62 | 83 | LWRE 3125 ACS | LWAKE 3 x 13 ACS |
| LWRE 3150 ACS - Kit | 9 090 | 13 600 | 79 | 100 | LWRE 3150 ACS | LWAKE 3 x 16 ACS |
| LWRE 3175 ACS - Kit | 9 964 | 15 300 | 94 | 117 | LWRE 3175 ACS | LWAKE 3 x 18 ACS |
| LWRE 3200 ACS - Kit | 11 653 | 18 700 | 100 | 133 | LWRE 3200 ACS | LWAKE 3 x 22 ACS |
| including 8 end pieces LWERE 3 | | | | | | |
| LWRE 4100 ACS - Kit | 14 536 | 16 640 | 40 | 67 | LWRE 4100 ACS | LWAKE 4 x 8 ACS |
| LWRE 4150 ACS - Kit | 19 944 | 24 960 | 79 | 100 | LWRE 4150 ACS | LWAKE 4 x 12 ACS |
| LWRE 4200 ACS - Kit | 26 170 | 35 360 | 96 | 133 | LWRE 4200 ACS | LWAKE 4 x 17 ACS |
| LWRE 4250 ACS - Kit | 30 859 | 43 680 | 129 | 167 | LWRE 4250 ACS | LWAKE 4 x 21 ACS |
| LWRE 4300 ACS - Kit | 36 452 | 54 080 | 152 | 200 | LWRE 4300 ACS | LWAKE 4 x 26 ACS |
| LWRE 4350 ACS - Kit | 41 813 | 64 480 | 175 | 233 | LWRE 4350 ACS | LWAKE 4 x 31 ACS |
| LWRE 4400 ACS - Kit | 45 964 | 72 800 | 203 | 267 | LWRE 4400 ACS | LWAKE 4 x 35 ACS |
| including 8 end pieces LWERE 4 | | | | | | |
| LWRE 6100 ACS - Kit | 22 826 | 23 400 | 37 | 67 | LWRE 6100 ACS | LWAKE 6 x 6 ACS |
| LWRE 6150 ACS - Kit | 31 318 | 35 100 | 71 | 100 | LWRE 6150 ACS | LWAKE 6 x 9 ACS |
| LWRE 6200 ACS - Kit | 39 196 | 46 800 | 105 | 133 | LWRE 6200 ACS | LWAKE 6 x 12 ACS |
| LWRE 6250 ACS - Kit | 49 056 | 62 400 | 117 | 167 | LWRE 6250 ACS | LWAKE 6 x 16 ACS |
| LWRE 6300 ACS - Kit | 56 093 | 74 100 | 151 | 200 | LWRE 6300 ACS | LWAKE 6 x 19 ACS |
| LWRE 6350 ACS - Kit | 65 107 | 89 700 | 163 | 233 | LWRE 6350 ACS | LWAKE 6 x 23 ACS |
| LWRE 6400 ACS - Kit | 71 640 | 101 400 | 197 | 267 | LWRE 6400 ACS | LWAKE 6 x 26 ACS |
| including 8 end pieces LWERE 6 | | | | | | |

LWR rail guides

LWR rail guides are well-proven, limited-travel linear guides used in numerous applications. They consist of two identical rails between which crossed roller assemblies or ball assemblies are inserted, depending on the respective application.

LWR rail guides with crossed roller assemblies are robust linear bearings with high load carrying capacity. Their special characteristics make them suitable for a large proportion of linear bearing arrangements with limited travel.

LWR rail guides with ball assembly can be used to advantage where loads are light and/or easy running is required.

Rail guides with a length greater than 1 200 mm are supplied in sections.

Because of the many permutations available, each part of an LWR rail guide must be ordered separately, e. g:

- 4 rails LWR 90600
- 2 crossed roller assemblies LWAL 9x25
- 8 end pieces LWERA 9

Ordering

To facilitate the order routine, rail guide sets can also be ordered in kit packaging (see pages 12-13).



Ball and crossed roller assemblies for LWR rail guides

Ball assemblies

Where moderate loads are to be supported by a rail guide and greater priority is given to smooth operation and low friction, the use of ball assemblies is recommended.

LWJK ball assemblies are provided with a plastic ball-retaining cage. These are available for sizes 1 and 2.

Crossed roller assemblies

Where greater stiffness is required, crossed roller assemblies are recommended. Various cage types are available, depending on the size of the rollers.

LWAK crossed roller assemblies are fitted as standard for size 3 with a plastic cage to retain the cylindrical rollers.

LWAL crossed roller assemblies are available in sizes 6 to 12 with aluminium cages. They comprise retained rollers.

End pieces for LWR rail guides

End pieces prevent the drift of the cage away from the loaded zone.

LWERA end pieces fulfil these requirements in low-load conditions combined with horizontal mounting.

Attachment screws for LWR rail guides

In particular in the case of long rail guides, heat treatment can lead to thermal expansion which will also influence the distance between the tap holes. Special attachment screws compensate for this longitudinal expansion.

LWGD special attachment screws can be used for all rails within the Modular Range.

SKF modular range

The LWR rail guides form the basis for the whole Modular Range system. All guides with designations commencing LWR... included in this catalogue are interchangeable with each other within a given dimension series. All external and attachment dimensions correspond with those of the LWR series.

LWR rail guides are available in a total of nine sizes. The "Modular Range" includes sizes 3, 6 and 9 which, according to experience, cover 80 % of the normal market requirements. To enable prompt delivery from stock, certain standard rail lengths have been defined.

SKF Modular Range rail guides are specially highlighted in the tables. For further information, please refer to pages 5 to 7.

LWR rail guides

LWR 3 - LWR 12

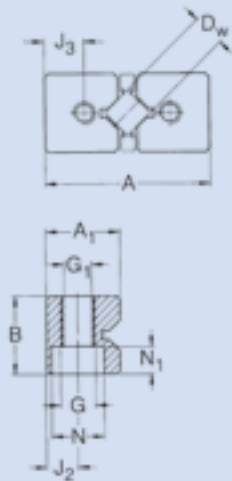

LWRB 1 + 2

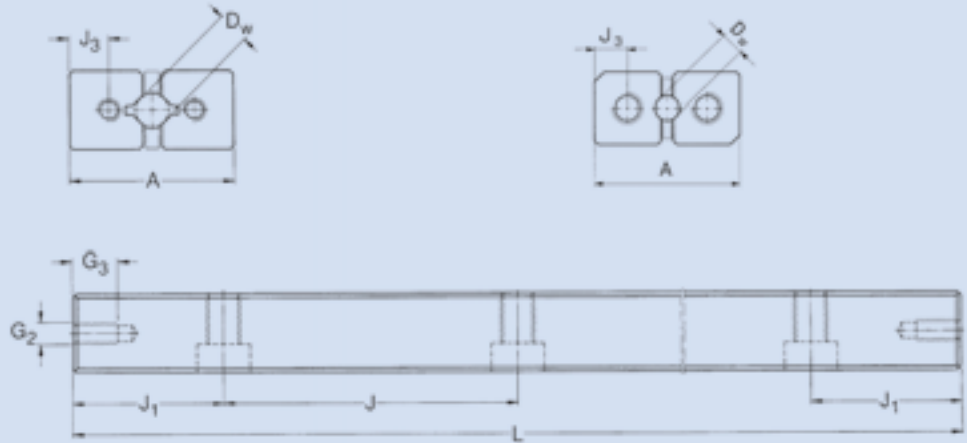

| Designation | Designation new | Dimensions: System | | | | Mounting holes | | | | | | End face holes | | | Available lengths | | | | | | |
|-------------|-----------------|--------------------|---|----------------|----------------|----------------|----------------|----------------|----|----------------|-----|----------------|----------------|----------------|-------------------|-----------------|---|---|---|---|---|
| | | A | B | A ₁ | D _w | J | J ₁ | J ₂ | G | G ₁ | N | N ₁ | J ₃ | G ₂ | G ₃ | L ¹⁾ | | | | | |
| | | | | | | | | | | | | | | | mm | | | | | | |
| LWRB 1 | LW 0804 | 8,5 | 4 | 3,9 | 1,6 | 10 | 5 | 1,8 | M2 | 1,65 | 3 | 1,4 | 1,9 | M1,6 | 2 | • | • | • | • | • | • |
| LWRB 2 | LW 1206 | 12 | 6 | 5,5 | 2 | 15 | 7,5 | 2,5 | M3 | 2,55 | 4,4 | 2 | 2,7 | M2,5 | 3 | • | • | • | • | • | • |

| Designation | Dimensions: System | | | | Mounting holes | | | | | | End face holes | | | Available lengths | | | | | | | | |
|-------------|--------------------|----|----------------|----------------|----------------|----------------|----------------|-----|----------------|------|----------------|----------------|----------------|-------------------|-----------------|---|---|---|---|---|---|---|
| | A | B | A ₁ | D _w | J | J ₁ | J ₂ | G | G ₁ | N | N ₁ | J ₃ | G ₂ | G ₃ | L ¹⁾ | | | | | | | |
| | | | | | | | | | | | | | | | mm | | | | | | | |
| LWR 3 | 18 | 8 | 8,2 | 3 | 25 | 12,5 | 3,5 | M4 | 3,3 | 6 | 3,2 | 4 | M3 | 6 | ■ | ■ | ■ | ■ | ■ | ■ | ○ | • |
| LWR 6 | 31 | 15 | 13,9 | 6 | 50 | 25 | 6 | M6 | 5,2 | 9,5 | 5,2 | 7 | M5 | 9 | ■ | ○ | ■ | ■ | ■ | ■ | ○ | ■ |
| LWR 9 | 44 | 22 | 19,7 | 9 | 100 | 50 | 9 | M8 | 6,8 | 10,5 | 6,2 | 10 | M6 | 9 | ■ | ○ | ■ | ■ | ■ | ■ | ○ | ■ |
| LWR 12 | 58 | 28 | 25,9 | 12 | 100 | 50 | 12 | M10 | 8,5 | 13,5 | 8,2 | 13 | M8 | 12 | ■ | ○ | ■ | ■ | ■ | ■ | ○ | ■ |

¹⁾ Sizes LWR 15, 18 and 24 are available on request.

Ball and crossed roller assemblies

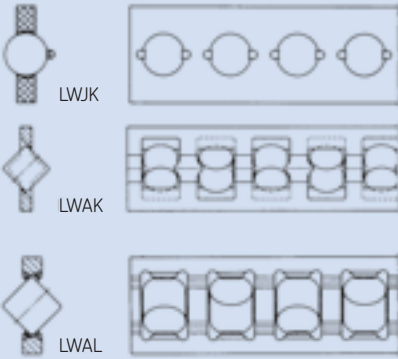

End pieces

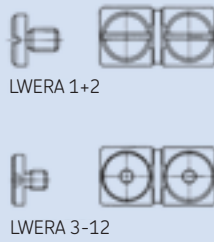

Special attachment screws



| | | | | | | | | | | | | Ball and crossed roller assemblies | End pieces ¹⁾ | Special-attachment screws | |
|-----|-----|-----|-----|-----|-----|-----|-----|-----|-----|-----|-----|------------------------------------|--------------------------|---------------------------|------|
| 070 | 075 | 080 | 090 | 100 | 105 | 120 | 135 | 150 | | | | LWJK | LWERA | LWGD | |
| ○ | ● | ○ | ○ | ○ | ● | ● | ○ | ○ | | | | ● | ● | | |
| | | | | | | | | | | | | Ball and crossed roller assemblies | End pieces ¹⁾ | Special-attachment screws | |
| 275 | 300 | 350 | 400 | 450 | 500 | 550 | 600 | 650 | 700 | 800 | 900 | 1 000 | LWJK LWAL | LWERA | LWGD |
| ○ | ● | ■ | ● | ■ | ● | ○ | ○ | ○ | ○ | | | | ● | ● | ● |
| | ■ | | ■ | | ■ | | ● | ● | ○ | ○ | ○ | ○ | ● | ● | ● |
| | ○ | ○ | ○ | ○ | ○ | ○ | ● | ○ | ○ | ○ | ○ | ○ | ● | ● | ● |

- SKF Modular Range. Preferred range, prompt delivery
- Prompt delivery
- Available to order

Example: 4 LWR 3100 or 4 LWR 90200
 2 LWAK 3 x 17 2 LWAL 9x10
 8 LWERA 3 4 LWERA 9

Accessories for LWR rail guides

Ball and crossed roller assemblies

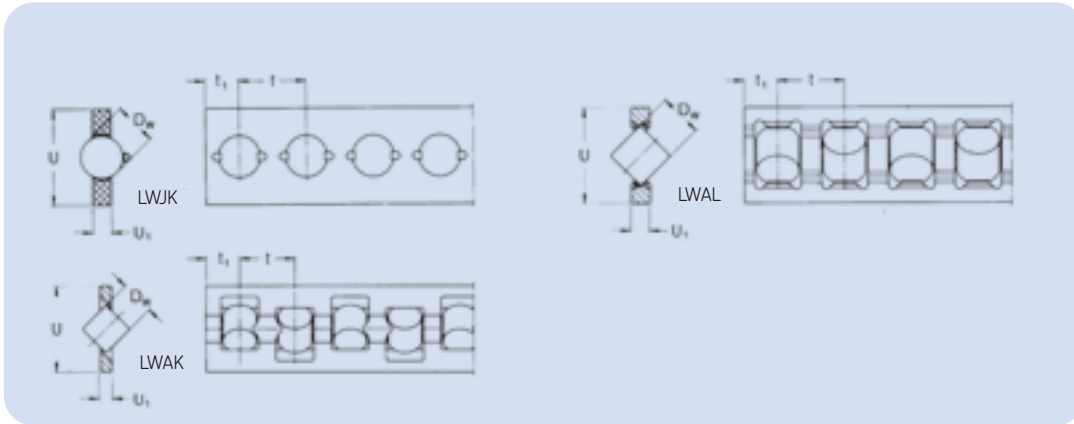

For description and data relating to rolling element assemblies, see page 15

| Designation ¹⁾ | Dimensions | | | | | Load ratings for 10 rolling elements | | Appropriate rail guide |
|---------------------------|----------------|------|----------------|-----|----------------|--------------------------------------|-----------------------|------------------------|
| | D _w | U | U ₁ | t | t ₁ | dynamic C | static C ₀ | |
| | mm | | | | | N | | |
| LWJK 1,588 | 1,588 | 3,5 | 0,5 | 2,2 | 1,0 | 410 | 580 | LWRB 1 |
| LWJK 2 | 2 | 5 | 0,75 | 3,9 | 1,5 | 640 | 720 | LWRB 2 |
| LWAK 3 | 3 | 7,5 | 1 | 5 | 3,5 | 1 320 | 1 600 | LWR 3 |
| LWAL 6 | 6 | 14,8 | 2,7 | 9 | 6 | 5 850 | 6 800 | LWR 6 |
| LWAL 9 | 9 | 20 | 4 | 14 | 9,4 | 17 000 | 18 300 | LWR 9 |
| LWAL 12 | 12 | 25 | 5 | 18 | 12 | 30 000 | 30 500 | LWR 12 |

End pieces

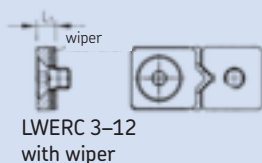
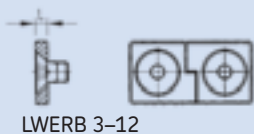
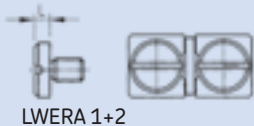

Special attachment screws

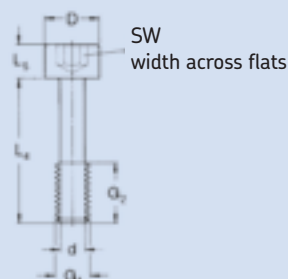

| Designation | End pieces with wiper | Dimensions | | Appropriate attachment screw | Designation Special attachment screws | Dimensions | | | | | | | |
|-------------|--------------------------|------------|----------------|------------------------------------|--|------------------------|-----|----|----|---|------|------------------|-----|
| | | L | L ₁ | | | G1 | G2 | L4 | L5 | D | d | SW ²⁾ | |
| | | mm | | DIN 963 | mm | | | | | | | | |
| LWERA 1 | - | 1 | - | M 1,6 | - | - | - | - | - | - | - | - | |
| LWERB 1 | - | 0,5 | - | M 1,6 | - | - | - | - | - | - | - | - | |
| LWERA 2 | - | 1,5 | - | M 2,5 | - | - | - | - | - | - | - | - | |
| LWERB 2 | - | 0,5 | - | M 2,5 | - | - | - | - | - | - | - | - | |
| LWERA 3 | - | 2,5 | - | M 3 | LWGD 3 | M 3 | 5 | 12 | 3 | 5 | 2,3 | 2,5 | |
| LWERB 3 | - | 2 | - | M 3 | DIN 7991 | - | - | - | - | - | - | - | |
| - | LWERC 3 | 2 | 5 | M 3 | | LWGD 4 (für LWRE 4) | M 3 | 5 | 16 | 3 | 5 | 2,3 | 2,5 |
| LWERA 6 | - | 3 | - | M 5 | LWGD 6 | M 5 | 8 | 20 | 5 | 8 | 3,9 | 4 | |
| LWERB 6 | - | 3 | - | M 5 | DIN 7991 | - | - | - | - | - | - | - | |
| - | LWERC 6 | 3 | 6 | M 5 | | LWGD 9 | M 6 | 12 | 30 | 6 | 8,5 | 4,6 | 5 |
| LWERA 9 | - | 4 | - | M 6 | DIN 7991 | - | - | - | - | - | - | - | |
| LWERB 9 | - | 4 | - | M 6 | | LWGD 12 | M 8 | 17 | 40 | 8 | 11,3 | 6,2 | 6 |
| - | LWERC 9 | 4 | 7 | M 6 | | - | - | - | - | - | - | - | - |
| LWERA 12 | - | 5 | - | M 8 | - | - | - | - | - | - | - | - | |
| LWERB 12 | - | 5 | - | M 8 | DIN 7991 | - | - | - | - | - | - | - | |
| - | LWERC 12 | 5 | 8 | M 8 | | - | - | - | - | - | - | - | |

²⁾ Width across flats of internal hexagon

LWRE rail guides

LWRE rail guides are a logical development of the proven LWR rail guides. Within the Modular Range system the LWRE rail guides offer an outstanding price/performance ratio.

Alongside the familiar characteristics of the LWR series, the new LWRE rail guides offer the advantages of a fivefold increase in the load carrying capacity and a doubling of the stiffness, achieved through optimised internal geometry in conjunction with larger roller diameters.

LWRE rail guides offer a greatly increased safety margin, thus a very much smaller LWRE rail guide can be used in a given design space while maintaining the same load carrying capacity as the LWR.

The mounting and attachment dimensions of the LWRE rail guides conform to those of all the SKF Modular Range rail guides included in this catalogue.

Rail guides of more than 1 200 mm in length should be built up of sections. Because of the many permutations available, each part of an LWRE rail guide must be ordered separately, e.g.:

4 rails LWRE 6200

2 crossed roller assemblies

LWAKE 6x13

4 end pieces LWERE 6

Ordering

To facilitate the order routine, rail guide sets can also be ordered in kit packaging (see pages 12-13).



Crossed roller assemblies for LWRE rail guides

LWAKE crossed roller cages consist of individual plastic elements.

In LWAKE 3, 6 and 9 cages, these elements are assembled using a 'snap in' technique whereby each element can be rotated manually through an angle of 90°. Thus the load rating and stiffness can be enhanced by turning the rollers in the direction of the load.

Dimensional stability of the LWAKE crossed roller assembly is maintained up to a temperature of +80 °C. The cage retains the rollers and at the same time almost fills the free space between the rails, thus providing good protection against the ingress of dirt.

LWAKE 4 cages consist of roller segments which are fitted together to the customer's specific length requirements.

End pieces for LWRE rail guides
End pieces prevent the drift of the cage away from the loaded zone.

LWRE end pieces are generally used for horizontal and vertical applications.

All end pieces are supplied with appropriate fixing screws.

Special attachment screws for LWRE rail guides

For designations and dimensions please refer to the LWR table on page 19. The LWGD special attachment screws listed in the table may be selected to suit each size of LWRE rail guide.

Internal geometry of LWR and LWRE rail guides

Normal LWR rail guides utilise only about 40 % of the roller length. Due to the parallel displacement of the load axes, LWR rail guides are prone to an internal tilting moment on the rollers. This can lead to high edge stresses and hence to a reduction of load carrying capacity. LWRE rail guides, on the other hand, utilise the whole roller length. Their internal geometry is such that no tilting moment can occur and there are no edge stresses.

At the same time the diameter of the rollers has been considerably increased (+33 %). These features provide the following advantages:

- fivefold increase in load carrying capacity
- 100 % increase in stiffness

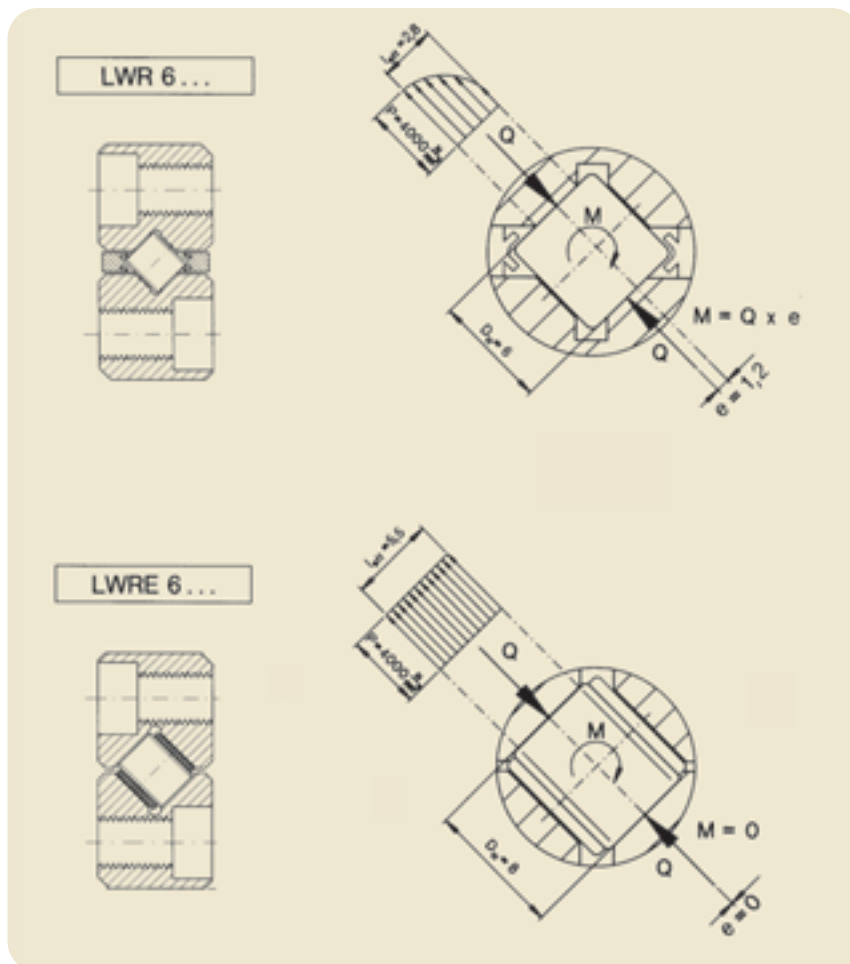

LWRE rail guides

LWRE 3 - LWRE 9 / LWRE 2211

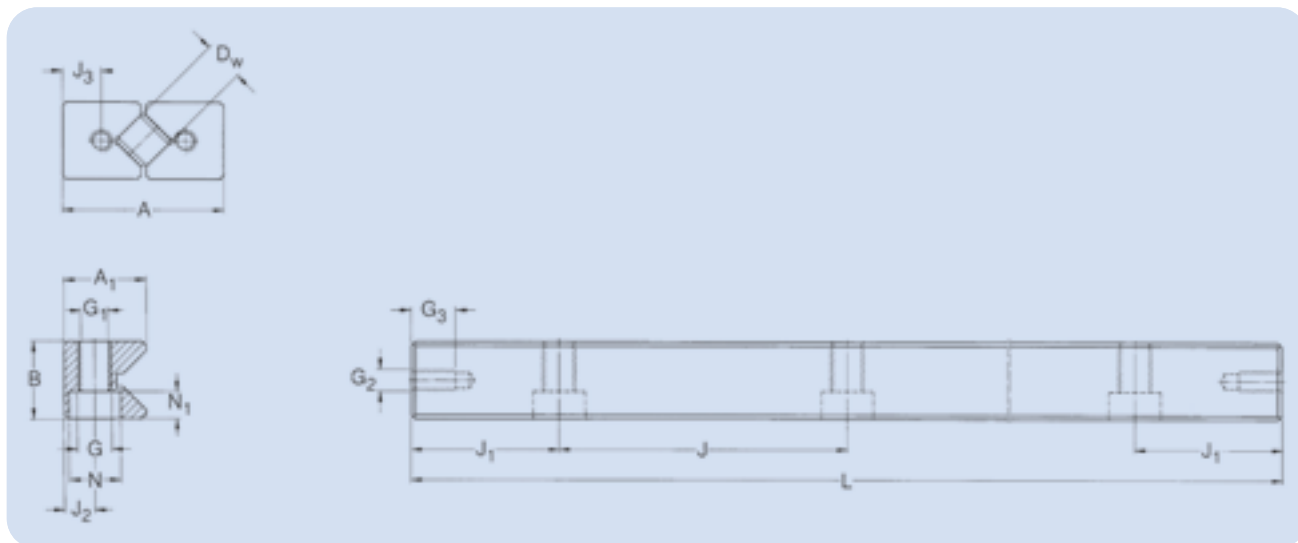

| Designation | New designation | Dimensions: System | | | | Attachment holes | | | | | | | End face holes | | | Available lengths | | | | | | | |
|-------------|-----------------|--------------------|----|----------------|----------------|------------------|----------------|----------------|-----|----------------|------|----------------|----------------|----------------|----------------|-------------------|-----|-----|-----|-----|-----|-----|-----|
| | | A | B | A ₁ | D _w | J | J ₁ | J ₂ | G | G ₁ | N | N ₁ | J ₃ | G ₂ | G ₃ | L ¹⁾ | 050 | 075 | 100 | 125 | 150 | 175 | 200 |
| | | mm | | | | | | | | | | | | | | | | | | | | | |
| LWRE 3 | LW 1808 | 18 | 8 | 8,7 | 4 | 25 | 12,5 | 3,5 | M 4 | 3,3 | 6 | 3,2 | 4 | M 3 | 6 | □ | □ | □ | □ | □ | □ | □ | □ |
| LWRE 4 | LW 2512 | 25 | 12 | 12 | 6,5 | 25 | 12,5 | 5 | M 4 | 3,3 | 6 | 3,2 | 5 | M 3 | 6 | | | • | | • | | • | |
| LWRE 6 | LW 3115 | 31 | 15 | 15,2 | 8 | 50 | 25 | 6 | M 6 | 5,2 | 9,5 | 5,2 | 6,75 | M 5 | 9 | | | □ | | □ | | □ | |
| LWRE 9 | LW 4422 | 44 | 22 | 21,7 | 12 | 100 | 50 | 9 | M 8 | 6,8 | 10,5 | 6,2 | 9,75 | M 6 | 9 | | | | | | | □ | |

| Designation | New designation | Dimensions: System | | | | Attachment holes | | | | | | | End face holes | | | Available lengths | | | | | | | |
|-------------|-----------------|--------------------|----|----------------|----------------|------------------|----------------|----------------|-----|----------------|-----|----------------|----------------|----------------|----------------|-------------------|-----|-----|-----|-----|--|--|--|
| | | A | B | A ₁ | D _w | J | J ₁ | J ₂ | G | G ₁ | N | N ₁ | J ₃ | G ₂ | G ₃ | L ¹⁾ | 080 | 120 | 160 | 200 | | | |
| | | mm | | | | | | | | | | | | | | | | | | | | | |
| LWRE 2211 | LW 2211 | 22 | 11 | 10,7 | 4 | 40 | 20 | 4,5 | M 5 | 4,3 | 7,5 | 4,1 | 6 | M 3 | 6 | ○ | ○ | ○ | ○ | | | | |

¹⁾ Other lengths are available on request

Crossed roller assemblies



LWAKE

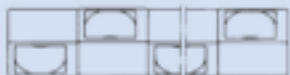

LWAKE

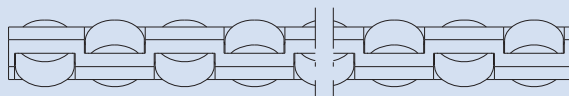

End pieces



LWAKE 3, 6, 9

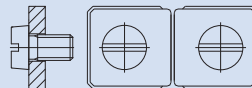

LWAKE 4

Special attachment screws



LWGD

| | | | | | | | | | | | | | Crossed roller assemblies | End pieces | Special attachment screws | | |
|-----|-----|-----|-----|-----|-----|-----|-----|-----|-----|-----|-----|-----|---------------------------|------------|---------------------------|-------|------|
| 225 | 250 | 275 | 300 | 350 | 400 | 450 | 500 | 550 | 600 | 650 | 700 | 800 | 900 | 1 000 | LWAKE | LWAKE | LWGD |
| ○ | ○ | ○ | ○ | | ● | ○ | ○ | ○ | ○ | | ○ | | | | ● | ● | ● |
| | ● | | ● | | ● | ○ | ○ | ○ | ○ | | ○ | | | | ● | ● | ● |
| | ■ | | ■ | ○ | ■ | ○ | ○ | ○ | ○ | ○ | ○ | | | | ● | ● | ● |
| | | | ■ | | ■ | | ■ | | ● | | ● | ○ | ○ | ○ | ● | ● | ● |

| | | | | | Crossed roller assemblies | End pieces | Special attachment screws |
|-----|-----|-----|-----|-----|---------------------------|------------|---------------------------|
| 240 | 280 | 320 | 360 | 400 | LWAKE | LWAKE | LWGD |
| ○ | ○ | ○ | ○ | ○ | ● | ● | |

- SKF Modular Range
Preferred range, prompt delivery
- Prompt delivery
- To special order

Ordering example: 4 LWRE 90400
 2 LWAKE 9 x 22
 4 LWAKE 9
 16 LWGD 9

Accessories for LWRE rail guides

Crossed roller assemblies



LWAKE 3, 6, 9



LWAKE 4

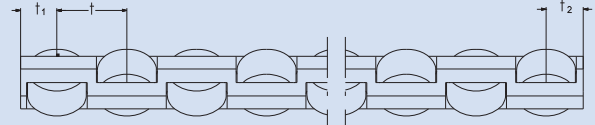

For description and data on crossed roller assemblies, please see page 21

| Designation | Dimension | | | | Load ratings for 10 needle rollers per row | | Rail guide designation |
|-------------|-----------|------|-------|-------|--|--------------|------------------------|
| | D_w | t | t_1 | t_2 | dynamic C | static C_0 | |
| | mm | | | | N | | |
| LWAKE 3 | 4 | 6,25 | 2,65 | 3,6 | 6 300 | 8 500 | LWRE 3, LWRE 2211 |
| LWAKE 4 | 6,5 | 8 | 4,3 | 4,3 | 17 300 | 20 800 | LWRE 4 |
| LWAKE 6 | 8 | 11 | 5 | 6 | 34 000 | 39 000 | LWRE 6 |
| LWAKE 9 | 12 | 16 | 7,35 | 8,65 | 78 000 | 78 000 | LWRE 9 |

End pieces

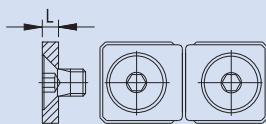

LWERE 3, 6, 9

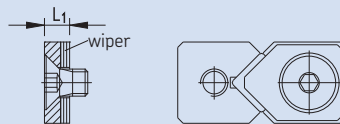

LWEREC 3, 6, 9

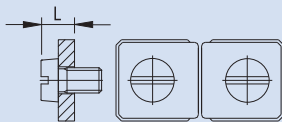

LWERE 4

Special attachment screws



LWGD

for designation and dimensions see page 19

| Designation | Dimensions | | Appropriate attachment screw | Rail guide designation |
|-------------|---------------|------------|------------------------------|------------------------|
| | without wiper | with wiper | | |
| | L | L_1 | | |
| | mm | | DIN 7991 | |
| LWERE 3 | | 2 | M 3 | LWRE 3, LWRE 2211 |
| | LWEREC 3 | 4 | M 3 | LWRE 3, LWRE 2211 |
| LWERE 4 | | 4 | M 3 (DIN 84) | LWRE 4 |
| LWERE 6 | | 3 | M 5 | LWRE 6 |
| | LWEREC 6 | 5 | M 5 | LWRE 6 |
| LWERE 9 | | 3 | M 6 | LWRE 9 |
| | LWEREC 9 | 6 | M 6 | LWRE 9 |

LWRE ACS rail guides with non-slip cage (Anti Creep System)



Many users are familiar with “cage-creep” in conventional precision rail guides. This effect occurs as a result of high acceleration and uneven pre-loading or load distribution. Thanks to a new design conceived by SKF Linersysteme GmbH, this drift of the cage away from its intended position is eliminated through a sophisticated “Anti Creep System”, in short ACS.

Precision rail guides with ACS increase the reliability of installations and lead to extended operating periods of the linear guides. Thus, damaged cages are a thing of the past.

Moreover, the exchange of guides and the resultant need for readjusting the machine or installation are eliminated.

LWRE ACS rail guides are equivalent to LWRE rail guides, designed for use in non-slip LWAKE cages.

The non-slip effect is achieved through a patented control gear attached to the cage which is in mesh between the LWRE ACS rails during operation, thus retaining the cage in its defined position.

The external dimensions of LWRE ACS rail guides are identical with those of LWRE rail guides. The non-slip guide has been integrated in the existing design. Thus, sizes LWRE 3 ACS, LWRE 6 ACS and LWRE 9 ACS fit into the Modular Range system. Sizes LWRE 4 ACS and LWRE 2211 ACS are available in addition. Split rail guides, rails of tolerance class P2 or P5 or protruding cages can be supplied upon request.

Advantages

- ACS eliminates “cage-creep”
- Increased accuracy thanks to defined positioning of cage
- Easily interchangeable with standard precision rails
- Identical size thanks to integral design
- Suitable for high acceleration, vertical mounting and uneven load distribution
- Less downtime and lower maintenance requirements

“Cage-creep” test results

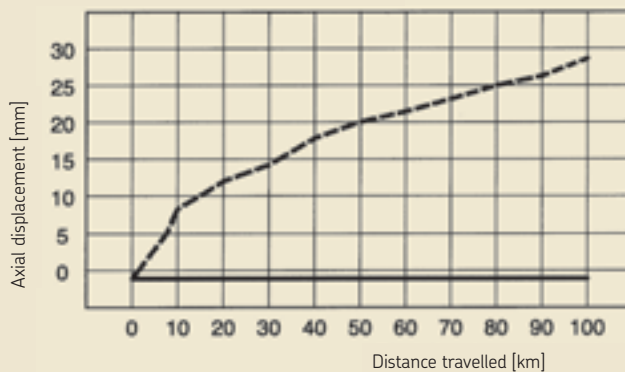

— Special cage of size 3 with ACS
 - - - Standard crossed roller cage of size 3

LWRE ACS rail guides can be designed for specified or maximum travel of the rail guide system. For systems with specified travel, the length of the stroke is quoted after the suffix ACS. LWAKE ACS cages must only be operated over the specified stroke length.

A rail guide with maximum travel is prepared for the use of ACS over its entire length. This may be required for mounting, maintenance or dismantling purposes. When placing an order, this design is specified by the suffix ACS, without a stroke, directly after the LWRE rail guide designation.

Ordering designation for LWRE ACS rail guides:

LWRE ACS rail guide for maximum travel of the rail system (see Fig. 11A):

LWRE rail ACS
e.g. LWRE 6200 ACS

LWRE ACS rail guides for specified travel of the rail system (see Fig. 11B):

LWRE rail ACS stroke (mm)
e.g. stroke: 100 mm
(cage travel: 50 mm)
LWRE 6200 ACS 100 mm

Because of the many permutations available, all parts of LWRE ACS rail guides are usually ordered separately, e.g.:

Maximum travel:

4 rails
2 crossed roller cages
8 end pieces

e.g.:

LWRE 6200 ACS
LWAKE 6x12 ACS (147,3 mm)
LWRE 6
(see Fig. 11A)

Specified travel:

4 rails
2 crossed roller cages
8 end pieces

e.g.:

LWRE 6200 ACS 100 mm
LWAKE 6x12 ACS (147,3 mm)
LWRE 6
(see Fig. 11B)

Ordering

To facilitate the order routine, rail guide sets can also be ordered in kit packaging (see pages 12 – 13).

Fig. 11 A

LWRE ACS rail guides for “maximum travel” stroke

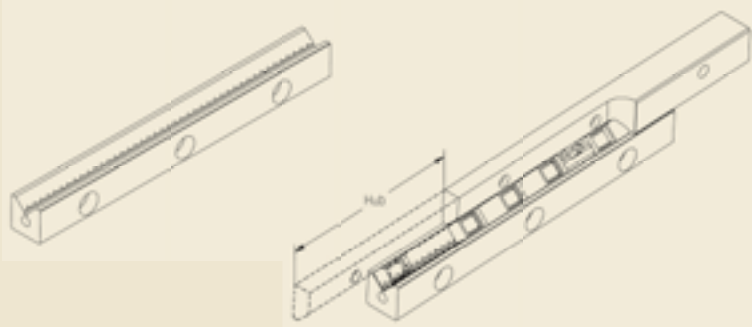
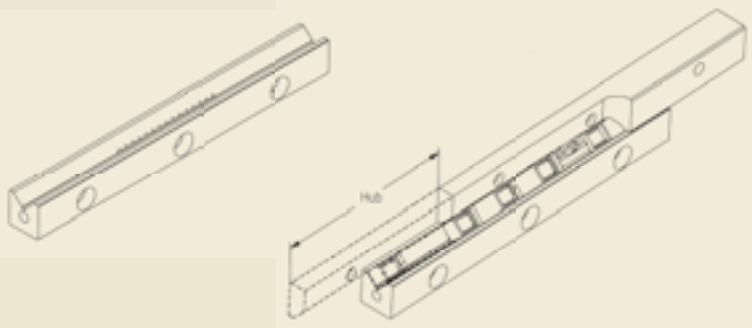

Fig. 11 B

LWRE ACS rail guides for “specified travel” stroke



Crossed roller assemblies for LWRE ACS rail guides

Compared to LWAKE cages, LWAKE ACS crossed roller cages incorporate an additional control gear located at the centre of the cage. The load carrying capacity of LWAKE ACS cages is identical with that of LWAKE standard cages, provided that they comprise an identical number of rollers. However, it has to be taken into consideration that, due to their additional control gear, LWAKE ACS cages are longer than the corresponding LWAKE cages, even if the number of rollers is identical. Protruding cages should be used only after consultation with SKF.

Ordering designation for LWAKE ACS cages:

LWAKE ACS cages should be ordered as follows:

LWAKE size x number of rollers ACS
For instance, an LWAKE 6 cage with 12 rollers and ACS control gear has the designation LWAKE 6x12 ACS (147,3 mm).

End pieces for LWRE ACS rail guides

As a rule, end pieces must not be used as a mechanical stroke limitation of the guidance system, as this can result in cage damage. End pieces can be used as a protection against external influences.

Special attachment screws for LWRE ACS rail guides

For designation and dimensions, please refer to LWR, page 19. The listed special attachment screws of type LWGD can also be used for mounting LWRE ACS rail guides, if their respective size is taken into consideration.

Design and mounting of LWRE ACS rail guides

Mounting of LWRE ACS rail guides proceeds to the same rules as mounting of SKF standard precision rails. In addition, it is essential to observe that the ACS control gear is constantly kept in mesh between the rails during operation. Furthermore, the cage must never be subjected to direct or indirect external axial loads. The ACS control gear must not be damaged during mounting, e.g. through the insertion of the ACS cage between the rails against an end stop, or tilting or twisting of two adjacent rails.

Protection and lubrication of LWRE ACS rail guides

In order to ensure the impeccable operation of the Anti Creep System, it should be protected against contamination and relubricated with moderate quantities of SKF standard grease. Any "blocking" or "gumming" of the element must be ruled out.

Accessories for LWRE ACS rail guides

Crossed roller assemblies

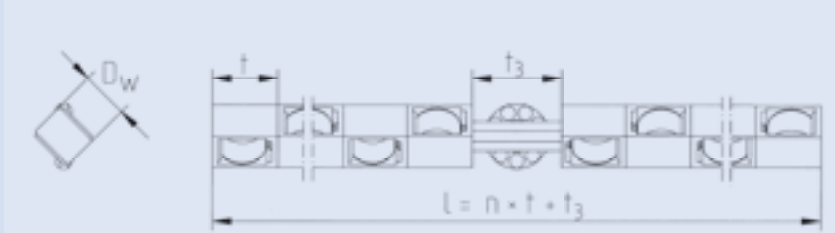

LWAKE 3, 6, 9 ACS

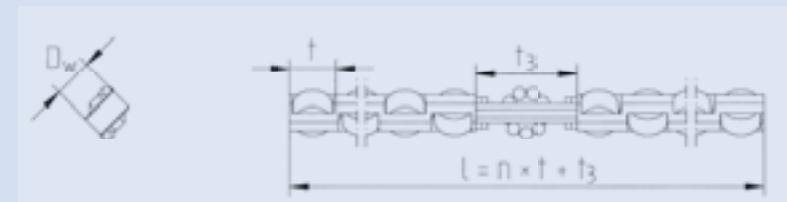

LWAKE 4 ACS

n = number of rollers

For description and data on crossed roller units, please see pages 21, 24 and 27.

| Designation | Dimensions | | | Load ratings for 10 needlerollers per row | | Rail guide designation |
|-------------|------------|------|-------|---|-----------------|---------------------------|
| | D_w | t | t_3 | dynamic C | static C_0 | |
| | mm | | | N | | |
| LWAKE 3 ACS | 4 | 6,25 | 9 | 6 300 | 8 500 | LWRE 3 ACS, LWRE 2211 ACS |
| LWAKE 4 ACS | 6,5 | 8 | 17 | 17 300 | 20 800 | LWRE 4 ACS |
| LWAKE 6 ACS | 8 | 11 | 15,3 | 34 000 | 39 000 | LWRE 6 ACS |
| LWAKE 9 ACS | 12 | 16 | 22 | 78 000 | 78 000 | LWRE 9 ACS |

End pieces

For designation and dimensions
please see LWRE, page 24.

Special attachment screws



LWGD

For designation and dimensions
please see LWR, page 19.

LWRM/LWRV rail guides

LWRM/LWRV rail guides offer guidance systems with high load carrying capacity and maximum stiffness.

Needle roller assemblies for LWRM/LWRV rail guides

LWHW needle roller assemblies have aluminium cages with retained needle rollers. They are available for size 6 and 9 units.

When ordering, the appropriate cage length in mm should be stated after the cage designation, e.g.: LWHW 10x225.

End pieces for LWRM/LWRV rail guides

End pieces serve to prevent the drift of the cage away from the loaded zone.

LWEARM and LWEARV end pieces feature a plastic wiper with a sealing lip that keeps the raceways free from contamination. All end pieces are supplied with the appropriate attachment screws.

The mounting and attachment dimensions of LWRM/LWRV rail guides conform to those of all the SKF Modular Range rail guides included in this catalogue.

Because of the many permutations available, each part of an LWRM/LWRV rail guide must be ordered separately, e.g.:

- 2 rails LWRM 90400
- 2 rails LWRV 90400
- 2 needle roller assemblies LWHW 15x358
- 2 end pieces LWEAM 9



LWRM/LWRV rail guides

LWRM/LWRV 6 and LWRM/LWRV 9

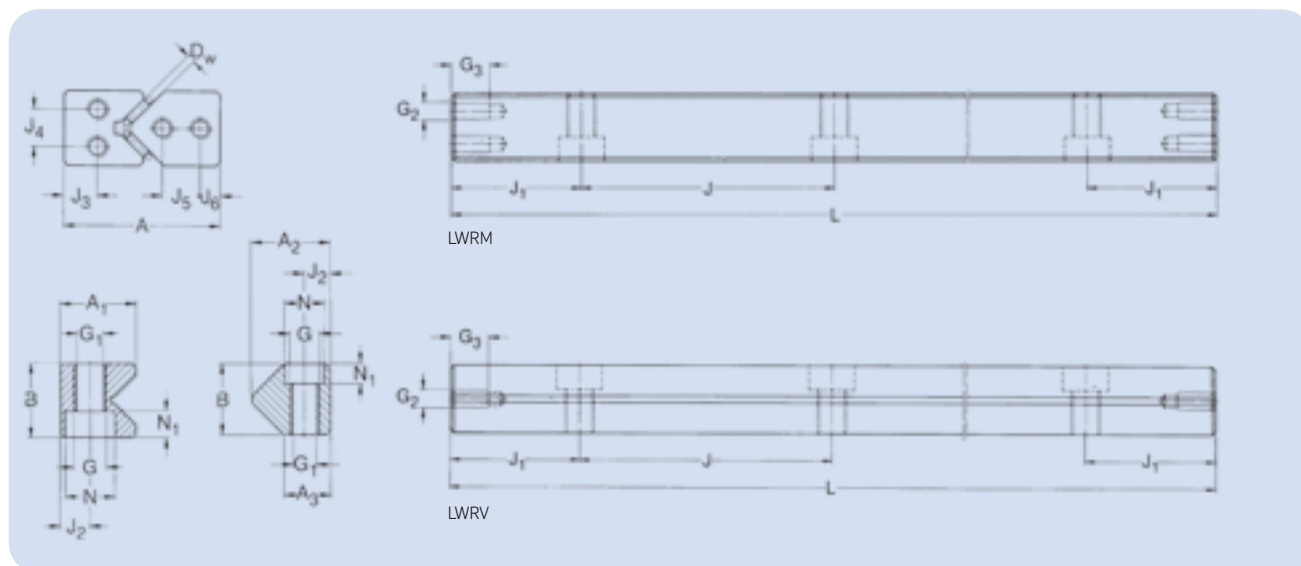

| Designation ¹⁾ | Dimensions: System | | | | | Attachment holes | | | | | | | | End face holes | | | | | |
|---------------------------|-----------------------|----|----------------|----------------|----------------|------------------|-----|----------------|----------------|-----|----------------|------|----------------|----------------|----------------|----------------|----------------|----------------|----------------|
| | A | B | A ₁ | A ₂ | A ₃ | D _w | J | J ₁ | J ₂ | G | G ₁ | N | N ₁ | J ₃ | J ₄ | J ₅ | J ₆ | G ₂ | G ₃ |
| mm | | | | | | | | | | | | | | | | | | | |
| LWRM 6 | 31 | 15 | 16,5 | – | – | 2 | 50 | 25 | 6 | M 6 | 5,2 | 9,5 | 5,2 | 8,5 | 7 | – | – | M 3 | 6 |
| LWRV 6 | 31 | 15 | – | 17,8 | 10,8 | 2 | 50 | 25 | 6 | M 6 | 5,2 | 9,5 | 5,2 | – | – | 7 | 6 | M 3 | 6 |
| LWRM 9 | 44 | 22 | 23,1 | – | – | 2 | 100 | 50 | 9 | M 8 | 6,8 | 10,5 | 6,2 | 10 | 11 | – | – | M 5 | 8 |
| LWRV 9 | 44 | 22 | – | 26,9 | 16,6 | 2 | 100 | 50 | 9 | M 8 | 6,8 | 10,5 | 6,2 | – | – | 10 | 6 | M 5 | 8 |

¹⁾Sizes LWRM/LWRV 12 and 15 as well as other rail lengths are available on request.

Needle roller assemblies



LWHW

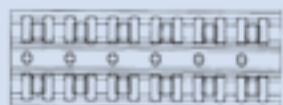

aluminium

End pieces



LWEARV
with wiper



LWEARM
with wiper



Special attachment screw



LWGD

Available lengths

L¹⁾

| Available lengths | | | | | | | | | | | | Needle roller assemblies | End pieces | | Special-attachment screws | |
|-------------------|-----|-----|-----|-----|-----|-----|-----|-----|-----|-----|-----|--------------------------|------------|--------|---------------------------|------|
| 100 | 150 | 200 | 250 | 300 | 350 | 400 | 500 | 600 | 700 | 800 | 900 | 1 000 | LWHW | LWEARM | LWEARV | LWGD |
| o | o | o | o | o | o | o | o | o | o | | | | • | • | - | • |
| o | o | o | o | o | o | o | o | o | o | | | | • | - | • | • |
| | | o | o | o | o | o | o | o | o | o | o | o | • | • | - | • |
| | | o | o | o | o | o | o | o | o | o | o | o | • | - | • | • |

- SKF Modular Range
Preferred range, prompt delivery
- Prompt delivery
- o To special order

Ordering example: 2 LWRM 90600
2 LWRV 90600
2 LWHW 15 x 450
4 LWEARM 9

Accessories for LWRM/LWRV rail guides

Needle roller assemblies



For description and data on needle roller assemblies, please see page 29

| Designation | Dimensions | | | | | Load ratings for 10 needle rollers per row | | Rail guide designation |
|-------------|------------|-------|----|------|-------|--|-----------------|------------------------------|
| | D_w | L_w | U | t | t_1 | dynamic C | static C_0 | |
| | mm | | | | | N | | |
| LWHV 10 | 2 | 4,8 | 10 | 3,75 | 2,7 | 10 400 | 25 500 | LWRM 6/LWRV 6 |
| LWHW 10 | 2 | 4,8 | 10 | 3,75 | 2,7 | 10 400 | 25 500 | LWRM 6/LWRV 6 |
| LWHV 15 | 2 | 7,8 | 15 | 3,75 | 2,7 | 16 300 | 45 000 | LWRM 9/LWRV 9 |
| LWHW 15* | 2 | 6,8 | 15 | 4,5 | 3,5 | 14 600 | 42 500 | LWRM 9/LWRV 9 |

End pieces

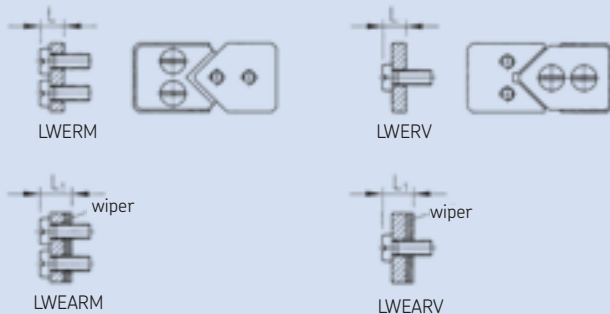

Special attachment screw



for designation and dimensions
see page 19

| Designation | Dimensions | | Appropriate attachment screws | Rail guide designation | |
|-------------|------------------|---------------|-------------------------------------|------------------------------|--------|
| | without wiper | with wiper | | | |
| | L | L_1 | | | |
| | mm | | | | |
| LWERM 6 | 4 | | M 3 | DIN 84 | LWRM 6 |
| LWERV 6 | 4 | | M 3 | DIN 84 | LWRV 6 |
| | | 6 | M 3 | DIN 84 | LWRM 6 |
| | | 6 | M 3 | DIN 84 | LWRV 6 |
| LWERM 9 | 6,3 | | M 5 | DIN 84 | LWRM 9 |
| LWERV 9 | 6,3 | | M 5 | DIN 84 | LWRV 9 |
| | | 8,3 | M 5 | DIN 84 | LWRM 9 |
| | | 8,3 | M 5 | DIN 84 | LWRV 9 |

* Higher load ratings are available on request

LWRPM/LWRPV rail guides

LWRPM/LWRPV rail guides are linear guides for limited travel, fitted with Turcite-B^{®1)} slide coating.

Based on PTFE, this material is self-lubricating and offers excellent sliding properties.

The coating is bonded to the non-hardened LWRPM rail and subsequently ground to size. The LWRPV rail is hardened and ground. In order to avoid damage to the sliding surface of the LWRPM rail, the leading edges of the LWRPV rails are slightly rounded. Otherwise, the dimensions of these rails are the same as those of the LWRV series.

LWRPM/LWRPV rail guides should be used where rail guides with rolling element assemblies are unsuitable due to external influences.

Such applications include those subjected to high transverse acceleration that may cause indentation of the rolling elements in the raceways, or where extremely short strokes are required. The unfavourable tribological conditions produced by such operation would give rise to race-way pitting in a rolling element rail guide.

The mounting and attachment dimensions of the LWRPM/LWRPV rail guides conform to those of all the SKF Modular Range rail guides included in this catalogue.

LWRPM/LWRPV rail guides are characterised by:

- stick-slip-free operation
- smooth running
- good emergency running properties
- low wear and high reliability
- insensitivity to contamination
- excellent vibration damping properties

When ordering, the individual components of the rail guides must be specified separately, e.g.:

2 rails LWRPM 6300

2 rails LWRPV 6300

¹⁾Turcite-B[®] is a registered trademark of Busak & Shamban GmbH



LWRPM/LWRPV rail guides

LWRPM/LWRPV 3 – LWRPM/LWRPV 9

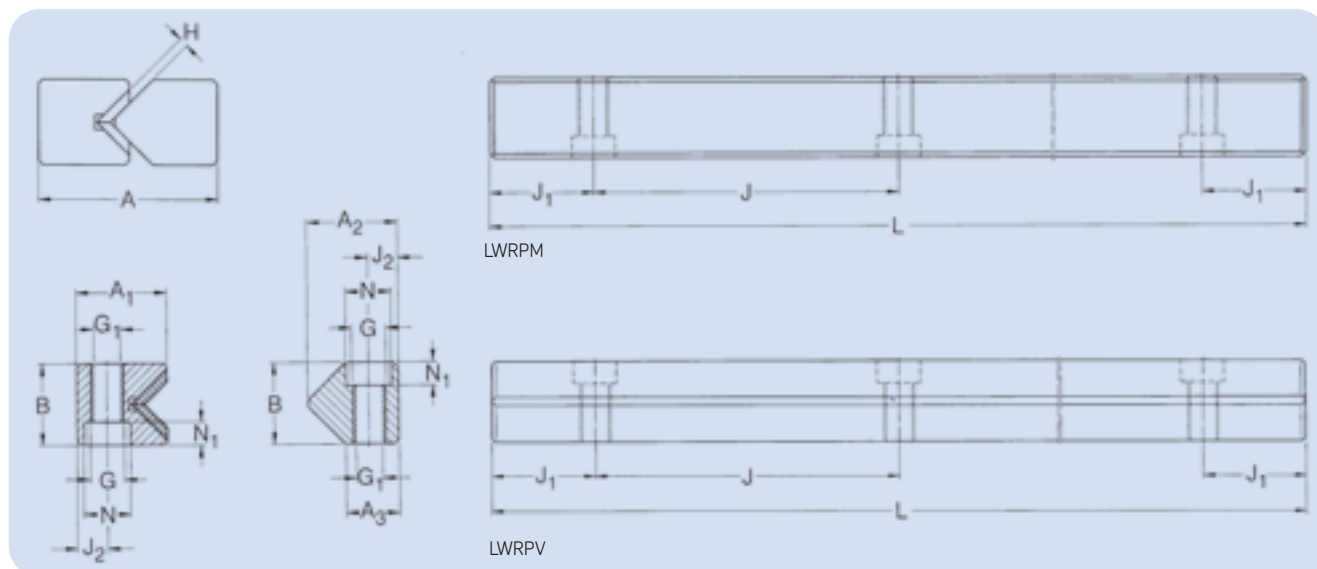

| Designation ¹⁾ | Dimensions: System | | | | | Attachment holes | | | | | | |
|---------------------------|-----------------------|----|----------------|----------------|----------------|------------------|----------------|----------------|-----|----------------|------|----------------|
| | A | B | A ₁ | A ₂ | A ₃ | J | J ₁ | J ₂ | G | G ₁ | N | N ₁ |
| | mm | | | | | | | | | | | |
| LWRPM 3 | 18 | 8 | 9,5 | – | – | 25 | 12,5 | 3,5 | M 4 | 3,3 | 6 | 3,2 |
| LWRPV 3 | 18 | 8 | – | 9,6 | 6,45 | 25 | 12,5 | 3,5 | M 4 | 3,3 | 6 | 3,2 |
| LWRPM 6 | 31 | 15 | 16,6 | – | – | 50 | 25 | 6 | M 6 | 5,2 | 9,5 | 5,2 |
| LWRPV 6 | 31 | 15 | – | 17,8 | 10,8 | 50 | 25 | 6 | M 6 | 5,2 | 9,5 | 5,2 |
| LWRPM 9 | 44 | 22 | 23,1 | – | – | 100 | 50 | 9 | M 8 | 6,8 | 10,5 | 6,2 |
| LWRPV 9 | 44 | 22 | – | 26,9 | 16,6 | 100 | 50 | 9 | M 8 | 6,8 | 10,5 | 6,2 |

¹⁾ Sizes LWRPM/LWRPV 12 and LWRPM/LWRPV 15 as well as other rail lengths are available on request.

Slide coating

LWRPM rail guides are provided with a slide coating bonded to the raceways and subsequently ground to size. Separate ordering of the slide coating is not required.

End pieces

Because of their design, rail guides of these series do not normally require the use of end pieces.

Special attachment screws

For designations and dimensions, see page 19.

Available lengths

Special attachment screws

L¹⁾

| 050 | 075 | 100 | 125 | 150 | 175 | 200 | 225 | 250 | 275 | 300 | 350 | 400 | 450 | 500 | 550 | 600 | 650 | 700 | 800 | 900 | 1 000 | LWGD | |
|-----|-----|-----|-----|-----|-----|-----|-----|-----|-----|-----|-----|-----|-----|-----|-----|-----|-----|-----|-----|-----|-------|------|---|
| o | o | o | o | o | o | o | o | o | o | o | | | | | | | | | | | | | • |
| o | o | o | o | o | o | o | o | o | o | o | | | | | | | | | | | | | • |
| | | o | | o | | o | | o | | o | o | o | o | o | o | o | o | o | | | | | • |
| | | o | | o | | o | | o | | o | o | o | o | o | o | o | o | o | | | | | • |
| | | | | | | o | | | | o | | o | | o | | o | | o | o | o | o | o | • |
| | | | | | | o | | | | o | | o | | o | | o | | o | o | o | o | o | • |

- SKF Modular Range Preferred range, prompt delivery
- Prompt delivery
- o To special order

Ordering example: 2 LWRPM 6400
2 LWRPV 6300

Accessories for LWRPM/LWRPV rail guides

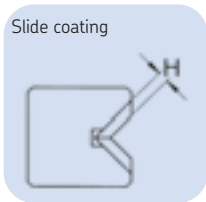

| Designation ¹⁾ | Dimensions | load carrying capacity ²⁾ | Rail guide designation |
|---------------------------|------------|--------------------------------------|------------------------|
| Rail guide | H mm | C N | |
| LWRPM 3 | 0,7 | 300/100 mm | LWRPV 3 |
| LWRPM 6 | 1,7 | 700/100 mm | LWRPV 6 |
| LWRPM 9 | 1,7 | 1 200/100 mm | LWRPV 9 |

¹⁾The slide coating is an integral part of the LWRPM rail and does not have to be ordered separately.

²⁾for a surface loading of approx. 1 N/mm² (momentary loads of up to 6 N/mm² are permissible).

End pieces

LWRPM/LWRPV rail guides, by virtue of their design, do not normally require end pieces.

For this reason, tapped holes on the end faces are also unnecessary.

However, for production reasons, LWRPV rail guides will in certain cases be supplied with end face holes.

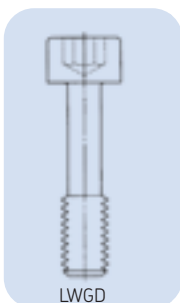

Special attachment screws

See page 19 for designations and dimensions.

LWM/LWV rail guides

LWM/LWV rail guides enable the design of linear guidance systems for heavy loads with maximum stiffness.

The internal geometry is identical with that of the Modular Range rails of the LWRM/LWRV series. As the same needle roller assembly is used, the load ratings are also the same. The external dimensions of the LWM/ LWV rail guides, however, differ slightly from those of the LWRM/LWRV Modular Range dimensions.

Yet LWM/LWV rail guides find wide application especially in machine tools. As standard they are supplied with attachment holes of type 15, i.e. through hole with counterbore.

If attachment hole type 13 is ordered, corresponding threaded inserts are supplied along with the guide.

For new designs the choice of LWRM/LWRV rail guides is recommended. These offer the advantage of being interchangeable with other rail guides of the Modular Range.

Needle roller assemblies for LWM/LWV rail guides

LWHW needle roller assemblies comprise an aluminium cage with needle rollers arranged at right angles to each other. The needle rollers are retained by the cage.

End pieces for LWM/LWV rail guides
End pieces serve to prevent drift of the cage away from the loaded zone.

LWEAM and LWEAV end pieces have the addition of a plastic wiper with a sealing lip that keeps the raceway free from dirt.

All end pieces are supplied together with attachment screws.

Rail guides with a length of more than 1 200 mm should be made up of sections. If, for design reasons, one-piece rails are required, these can be supplied to special order.



LWM/LWV rail guides

LWM/LWV 3015 – LWM/LWV 8050

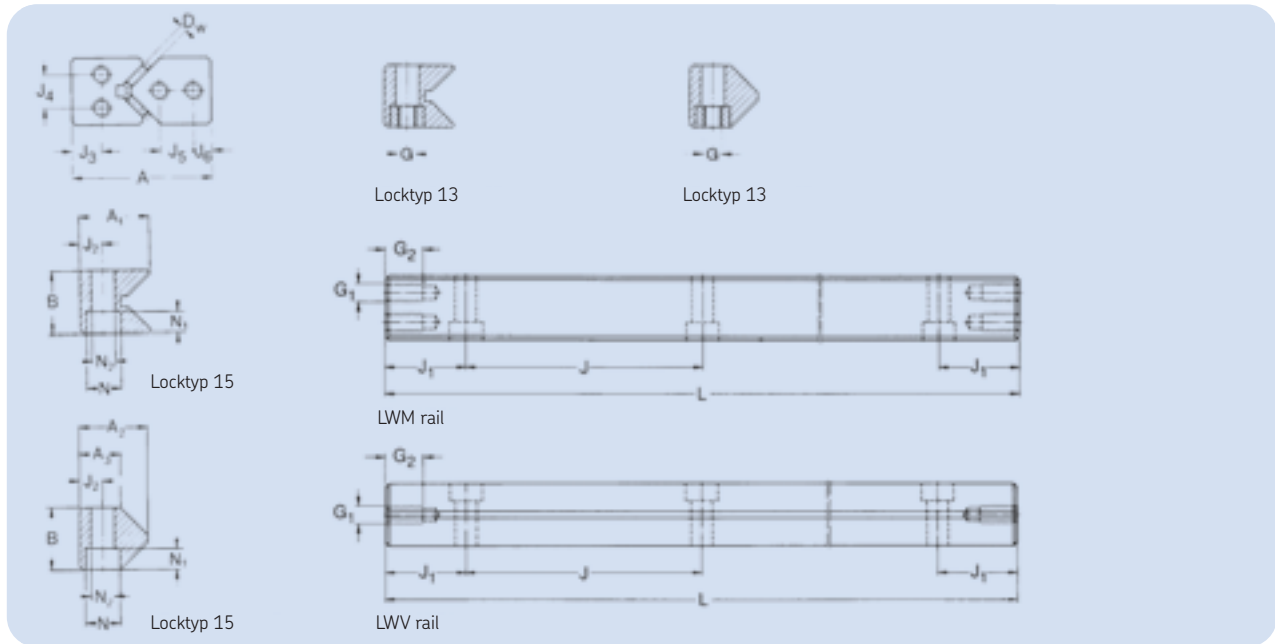

| Designation | Dimensions: Systems | | | | | | Attachment holes | | | | | | End face holes | | | | | | |
|-------------|------------------------|----|----------------|----------------|----------------|----------------|------------------|---------------------------------|----------------|------|------|----------------|----------------|----------------|----------------|----------------|----------------|----------------|----------------|
| | A | B | A ₁ | A ₂ | A ₃ | D _w | J ¹⁾ | J _{1min} ²⁾ | J ₂ | G | N | N ₁ | N ₂ | J ₃ | J ₄ | J ₅ | J ₆ | G ₁ | G ₂ |
| mm | | | | | | | | | | | | | | | | | | | |
| LWM 3015 | 30 | 15 | 16 | – | – | 2 | 40 | 15 | 5,5 | M 4 | 8,5 | 4,5 | 5,25 | 8 | 7 | – | – | M 3 | 6 |
| LWV 3015 | 30 | 15 | – | 17,2 | 10,5 | 2 | 40 | 15 | 5,5 | M 4 | 8,5 | 4,5 | 5,25 | – | – | 7 | 5,5 | M 3 | 6 |
| LWM 4020 | 40 | 20 | 22,3 | – | – | 2 | 80 | 15 | 7,5 | M 6 | 11,5 | 6,8 | 7,5 | 10 | 11 | – | – | M 5 | 7 |
| LWV 4020 | 40 | 20 | – | 22 | 13,5 | 2 | 80 | 15 | 7,5 | M 6 | 11,5 | 6,8 | 7,5 | – | – | 10,5 | 5,5 | M 5 | 7 |
| LWM 5025 | 50 | 25 | 28 | – | – | 2 | 80 | 20 | 10 | M 6 | 11,5 | 6,8 | 7,5 | 12 | 13 | – | – | M 6 | 8 |
| LWV 5025 | 50 | 25 | – | 28 | 17 | 2 | 80 | 20 | 10 | M 6 | 11,5 | 6,8 | 7,5 | – | – | 13 | 7 | M 6 | 8 |
| LWM 6035 | 60 | 35 | 36 | – | – | 2,5 | 100 | 20 | 11 | M 8 | 15 | 9 | 10 | 14 | 20 | – | – | M 6 | 8 |
| LWV 6035 | 60 | 35 | – | 36 | 20 | 2,5 | 100 | 20 | 11 | M 8 | 15 | 9 | 10 | – | – | 18 | 8 | M 6 | 8 |
| LWM 7040 | 70 | 40 | 40 | – | – | 3 | 100 | 20 | 13 | M 10 | 18,5 | 11 | 12,5 | 16 | 20 | – | – | M 6 | 8 |
| LWV 7040 | 70 | 40 | – | 42 | 24 | 3 | 100 | 20 | 13 | M 10 | 18,5 | 11 | 12,5 | – | – | 20 | 10 | M 6 | 8 |
| LWM 8050 | 80 | 50 | 45 | – | – | 3,5 | 100 | 20 | 14 | M 12 | 20 | 13 | 14 | 20 | 30 | – | – | M 6 | 8 |
| LWV 8050 | 80 | 50 | – | 48,5 | 26 | 3,5 | 100 | 20 | 14 | M 12 | 20 | 13 | 14 | – | – | 25 | 10 | M 6 | 8 |

¹⁾ for lengths $L < J + 2 \cdot J_{1min}$, $J = 50$ mm (except for LWM/LWV 3015)

²⁾ J_1 depends upon the rail length and is of the same size at each end of the rail

$$J_1 = \frac{L - \sum J}{2}$$

³⁾ $J = 35$ mm

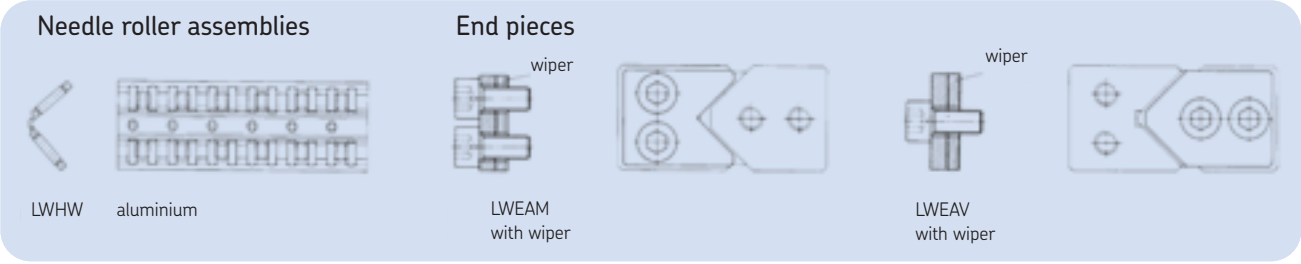

Available lengths⁴⁾

Needle roller assemblies

End pieces

| 100 | 150 | 200 | 300 | 400 | 500 | 600 | 700 | 800 | 900 | 1 000 | LWHW | LWEA | LWEAV |
|-----------------|-----|-----|-----|-----|-----|-----|-----|-----|-----|-------|------|------|-------|
| • ³⁾ | • | • | • | • | ○ | ○ | | | | | • | • | |
| • ³⁾ | • | • | • | • | ○ | ○ | | | | | • | | • |
| • | • | • | • | • | ○ | ○ | ○ | ○ | ○ | ○ | • | • | |
| • | • | • | • | • | ○ | ○ | ○ | ○ | ○ | ○ | • | | • |
| • | | • | • | • | ○ | ○ | ○ | ○ | ○ | ○ | • | | • |
| | | ○ | ○ | ○ | ○ | ○ | ○ | ○ | ○ | ○ | • | ○ | |
| | | ○ | ○ | ○ | ○ | ○ | ○ | ○ | ○ | ○ | • | ○ | ○ |
| | | ○ | ○ | ○ | ○ | ○ | ○ | ○ | ○ | ○ | • | ○ | ○ |
| | | ○ | ○ | ○ | ○ | ○ | ○ | ○ | ○ | ○ | • | ○ | ○ |
| | | ○ | ○ | ○ | ○ | ○ | ○ | ○ | ○ | ○ | • | ○ | ○ |
| | | ○ | ○ | ○ | ○ | ○ | ○ | ○ | ○ | ○ | • | ○ | ○ |

⁴⁾ other lengths available on request

- available from stock
- available to order

Ordering example: 2 LWM 4020200
 2 LWV 4020200
 2 LWHW 15x130
 4 LWEAM 4020

Accessories for LWM/LWV rail guides

Needle roller assemblies



For description and data on crossed roller assemblies, please see page 37.

| Designation | Dimensions | | | | | Load ratings for 10 needle rollers per row | | Rail guide designation |
|-------------|------------|-------|----|------|-------|--|--------------|------------------------|
| | D_w | L_w | U | t | t_1 | dynamic C | static C_0 | |
| | mm | N | | | | | | |
| LWHW 10 | 2 | 4,8 | 10 | 3,75 | 2,7 | 10 400 | 25 500 | LWM/LWV 3015 |
| LWHV 15 | 2 | 7,8 | 15 | 3,75 | 2,7 | 16 300 | 45 000 | LWM/LWV 4020 + 5025 |
| LWHW 15* | 2 | 6,8 | 15 | 4,5 | 3,5 | 14 600 | 42 500 | LWM/LWV 4020 + 5025 |
| LWHV 20 | 2,5 | 11,8 | 20 | 5 | 3,7 | 32 000 | 88 000 | LWM/LWV 6035 |
| LWHW 20* | 2,5 | 9,8 | 20 | 5,5 | 4,0 | 26 000 | 76 550 | LWM/LWV 6035 |
| LWHW 25* | 3 | 13,8 | 25 | 6 | 4,5 | 43 100 | 129 400 | LWM/LWV 7040 |
| LWHW 30* | 3,5 | 17,8 | 30 | 7 | 5,0 | 64 500 | 195 000 | LWM/LWV 8050 |

End pieces

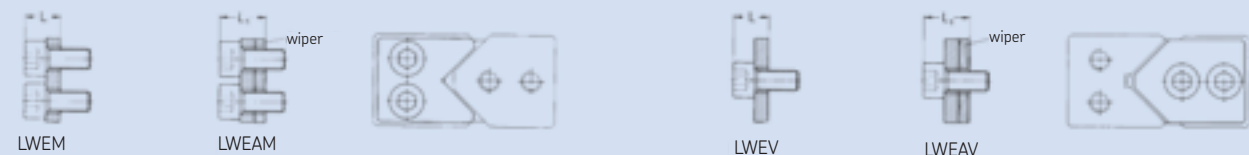

| Designation | Dimensions | | Appropriate attachment screws |
|-------------------------|---------------|------------|-------------------------------|
| | without wiper | with wiper | |
| | L | L_1 | |
| | mm | | |
| LWEM 3015 | 4 | | M 3 DIN 84 |
| LWEV 3015 | 4 | | M 3 DIN 84 |
| | | 6 | M 3 DIN 84 |
| | | 6 | M 3 DIN 84 |
| LWEM 4020 | 6,3 | | M 5 DIN 84 |
| LWEV 4020 | 6,3 | | M 5 DIN 84 |
| | | 8,3 | M 5 DIN 84 |
| | | 8,3 | M 5 DIN 84 |
| LWEM/LWEV 5025 bis 8050 | 6,9 | | M 6 DIN 84 |
| | | 8,9 | M 6 DIN 84 |

* Higher load ratings are available on request

LWJ/LWS flat rail guides

LWJ/LWS flat rail guides are used in conjunction with LWRM/LWRV, LWM/LWV or LWN/LWO rail guides as non-locating linear guides. They are incorporated in floating slides.

LWJ/LWS flat rail guides as well as the appropriate rolling element assemblies and end pieces are available to order.



LZM miniature slides



With the new LZM miniature slide product range SKF offers the ideal solution for linear motion applications for short strokes and compact boundary dimensions. The use of miniature slides has increased in medical applications, measurement technologies and micro mechanics & assembly.

The different LZM miniature slide components meet the highest precision standards. LZM miniature slides feature high running accuracy and smooth motion.

The LZM miniature slides are manufactured with all stainless steel components. Optimized hardness enables long endurance life and high performance within compact boundary dimensions.

The new LZM miniature slides have been designed to ensure high system stiffness and precision guidance.

Running accuracies of 2 μm over a stroke of 100 mm are attainable depending on the particular application. Ease of installation is another advantage of the LZM miniature slides. Unlike cross roller systems using 4 rails and cages to be assembled on the production floor, the LZM slide provides a complete slide that can simply be bolted into place without the use of precision devices to set preload.

Every application provides new challenges for the modern designer. SKF will modify existing designs to meet your specific technical requirements.

Applications:

- Pneumatics
- Semi conductor manufacturing
- Medical
- Micro- and electronics assembly
- Measurement applications
- Fiber optics

Advantages:

- Compact design
- High carrying capacity
- Very good running accuracy
- Smooth running
- High stiffness
- Easy assembly

Technical data

| | |
|------------------------|---|
| Structure | Four-point contact with identical load angles |
| Range | Four (4) sizes (7, 9, 12 and 15) |
| Temperature resistance | From -20 °C up to +80 °C |
| Speed | Up to 3 m/s |
| Acceleration | Up to 80 m/s ² (preloaded system) |
| Preload class | Three (3) preload classes (T0, T1 and T2) T0 = standard, light clearance T1 = light preload, very slight clearance T2 = medium preload, no clearance |
| Accuracy class | Two (2) accuracy classes (P1 and P5) P1 = high P5 = standard, for most applications |
| Lubrication | Slides are pre-lubricated with "Paraliq P460" |

Material specifications

| | |
|-----------------|--------------|
| Carriage & rail | Steel 1.4034 |
| Balls | Steel 1.3541 |
| End piece | Plastic |
| Cage | Plastic |

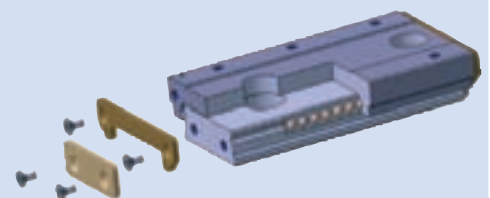

LZM miniature slide

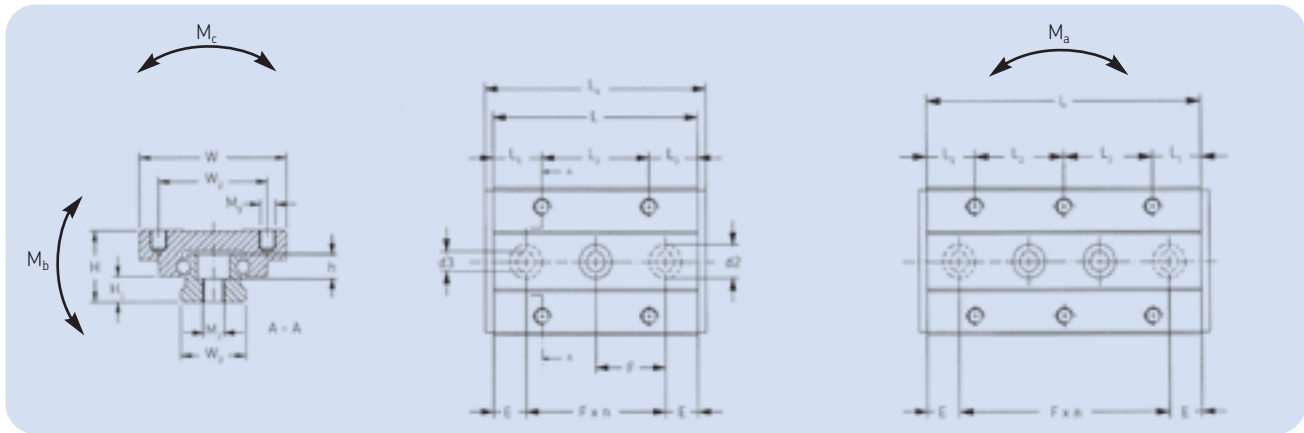

| Type | W | W ₂ | W ₃ | L ₂ | M ₁ x depth | d3 x d2 x h | H | H ₁ | M ₂ | F |
|-----------|----|----------------|----------------|----------------|------------------------|-----------------|----|----------------|----------------|----|
| mm | | | | | | | | | | |
| LZM HS 7 | 17 | 12 | 7 | 8 | M2 x 2,5 | 2,5 x 4,5 x 2,5 | 8 | 2,35 | M3 | 15 |
| LZM HS 9 | 20 | 15 | 9 | 13 | M3 x 3 | 3,5 x 6,0 x 3,5 | 10 | 3,55 | M4 | 20 |
| LZM HS 12 | 27 | 20 | 12 | 15 | M3 x 3,5 | 3,5 x 6,0 x 4,5 | 13 | 4,7 | M4 | 25 |
| LZM HS 15 | 32 | 25 | 15 | 20 | M3 x 4 | 3,5 x 6,0 x 4,5 | 16 | 6 | M4 | 40 |

| Type | L | L ₄ | E | L ₁ | max. stroke | Number of holes carriage rail | | C | C ₀ | Ma/Mb | Mc |
|-----------|-----|----------------|------|----------------|-------------|-------------------------------|---|-------|----------------|-------|-----|
| mm | | | | | | | | | | | |
| - | | | | | | | | | | | |
| N | | | | | | | | | | | |
| Nm | | | | | | | | | | | |
| LZM HS 7 | 26 | 29 | 5,5 | 5 | 24 | 6 | 2 | 700 | 1 100 | 3,5 | 6 |
| | 34 | 37 | 9,5 | 5 | 34 | 8 | 2 | 900 | 1 400 | 5,5 | 7 |
| | 50 | 53 | 10 | 5 | 50 | 12 | 3 | 1 100 | 2 000 | 12 | 10 |
| | 66 | 69 | 10,5 | 5 | 66 | 16 | 4 | 1 400 | 2 700 | 21 | 14 |
| LZM HS 9 | 32 | 35 | 8 | 9,5 | 28 | 4 | 2 | 1 200 | 1 800 | 7 | 12 |
| | 42 | 45 | 11 | 8 | 40 | 6 | 2 | 1 400 | 2 100 | 11 | 15 |
| | 55 | 58 | 7,5 | 8 | 54 | 8 | 3 | 1 900 | 3 400 | 18 | 19 |
| | 81 | 84 | 10,5 | 8 | 78 | 12 | 4 | 2 500 | 4 900 | 43 | 29 |
| | 94 | 97 | 7 | 8 | 92 | 14 | 5 | 2 700 | 5 500 | 57 | 33 |
| LZM HS 12 | 37 | 40 | 6 | 11 | 32 | 4 | 2 | 2 200 | 3 300 | 11 | 21 |
| | 51 | 54 | 13 | 10,5 | 47 | 6 | 2 | 2 600 | 4 300 | 22 | 28 |
| | 66 | 69 | 8 | 10,5 | 62 | 8 | 3 | 3 000 | 5 300 | 36 | 36 |
| | 96 | 99 | 10,5 | 10,5 | 95 | 12 | 4 | 3 800 | 7 200 | 76 | 52 |
| | 126 | 129 | 13 | 10,5 | 122 | 16 | 6 | 4 700 | 9 700 | 131 | 68 |
| LZM HS 15 | 52 | 56 | 6 | 16 | 50 | 4 | 2 | 2 800 | 3 900 | 25 | 42 |
| | 85 | 89 | 22,5 | 12,5 | 80 | 8 | 2 | 4 600 | 7 800 | 73 | 70 |
| | 105 | 109 | 12,5 | 12,5 | 102 | 10 | 3 | 5 100 | 9 100 | 106 | 84 |
| | 165 | 169 | 22,5 | 12,5 | 162 | 16 | 4 | 7 300 | 15 000 | 264 | 131 |

Order example: Miniatur slide unit Standard Size Length (L)
LZM HS 9 - 32

Standard slides

Design and characteristic features

General

The range of slides shown in this catalogue is standardised in terms of design, sizes and type of bearing. Slides differing from those included here, in design and drill hole pattern can only be produced economically in large batches.

GCL standard slides

Slide top and base of blackened steel or GG25 (cast iron) depending on size.

These slides are provided with standard patterns of mounting holes. The slide top carries tapped holes and the base plate counterbored holes to DIN 74 Form K for cylindrical screws to DIN 912. Both the upper and lower surfaces of the slides are

ground. The surface of the side opposite to the set screws is ground parallel to the slide axis and can therefore be used as a reference face. Internal stops serve as stroke limits. The slides are fitted with SKF precision rail guides type LWR with cross roller cage assemblies type LWAK (plastic) for GCL 3 or type LWAL (aluminium) for GCL 6. The mounting orientation is optional.



Technical data

Tolerances

Slide straightness: height Tz
side Ty

GCL and RM standard slides

| Tolerance (P10) | Stroke [mm] | | | | | | |
|-------------------------|-------------|----|-----|-----|-----|-----|-----|
| | 25 | 50 | 100 | 200 | 300 | 400 | 500 |
| | μm | | | | | | |
| Straightness: height Tz | 2 | 2 | 3 | 3 | 4 | 4 | 5 |
| Straightness: side Ty | 2 | 2 | 2 | 3 | 3 | 4 | 4 |

Specific features

The standard slides are fitted with limited-stroke rail guides, with cross roller units.

Permissible speed and acceleration

The rail guides can run at speeds up to **2 m/s** and accelerations up to **10 m/s²** are acceptable.

Preload

Preload is applied by set screws fitted along one side of the slide top. The standard slides are preloaded to approximately 10 % of the static load rating.

Materials

GCL Standard slides

- slide top and base: blackened steel or GG25 (cast iron), depending on size

For all slides

- guide rails: tool steel 1.2842 (90MnCrV9) hardened
- rolling elements: carbon chromium steel 1.3505 (100Cr6) hardened
- cage: plastic PA12 or aluminium, depending on size

Permissible operating temperature

-30 °C to +80 °C

Friction

The slides are free from stickslip. With normal light lubrication they have a coefficient of friction of between 0,003 and 0,005.

Lubrication

Rail guides of standard slides are lightly greased on assembly with SKF LGMT2 grease, a multi-purpose lithium based grease which also serves as protection against corrosion. It can be used in all standard applications.

Standard slides

GCL - Drill hole pattern in top plate

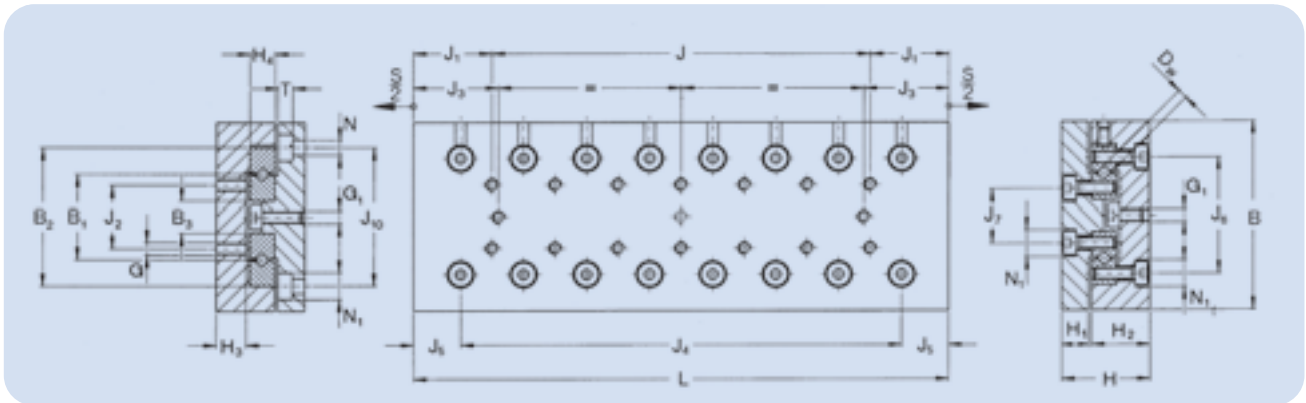

| Designations | Dimensions | | | Stroke S | Drill hole pattern dimensions | | | | | | | | | | | | | |
|--------------|-------------------|-----------|-----|-------------|-------------------------------|----------------|----------------|----------------|----|----------------|----------------|----------------|----------------|----------------|------|----------------|----------------|--|
| | B -0,2 -0,4 | H ±0,1 | L | | B ₁ | B ₂ | B ₃ | D _w | G | G ₁ | H ₁ | H ₂ | H ₃ | H ₄ | J | J ₁ | J ₂ | |
| mm | | | | | | | | | | | | | | | | | | |
| GCL 3050 | 60 | 28 | 55 | 30 | 28 | 46 | 10 | 3 | M4 | M4 | 9 | 18,5 | 10 | 8 | - | 27,5 | 25 | |
| GCL 3075 | | | 80 | 45 | | | | | | | | | | | 1x25 | | | |
| GCL 3100 | | | 105 | 60 | | | | | | | | | | | 2x25 | | | |
| GCL 3125 | | | 130 | 75 | | | | | | | | | | | 3x25 | | | |
| GCL 3150 | | | 155 | 90 | | | | | | | | | | | 4x25 | | | |
| GCL 3175 | | | 180 | 105 | | | | | | | | | | | 5x25 | | | |
| GCL 3200 | | | 205 | 130 | | | | | | | | | | | 6x25 | | | |
| GCL 6100 | 100 | 45 | 110 | 60 | 45 | 76 | 14 | 6 | M6 | M5 | 13 | 31 | 15,5 | 15 | - | 55 | 50 | |
| GCL 6150 | | | 160 | 95 | | | | | | | | | | | 1x50 | | | |
| GCL 6200 | | | 210 | 130 | | | | | | | | | | | 2x50 | | | |
| GCL 6250 | | | 260 | 165 | | | | | | | | | | | 3x50 | | | |
| GCL 6300 | | | 310 | 200 | | | | | | | | | | | 4x50 | | | |
| GCL 6400 | | | 410 | 280 | | | | | | | | | | | 6x50 | | | |

Standard slides

GCL - Drill hole pattern in base plate

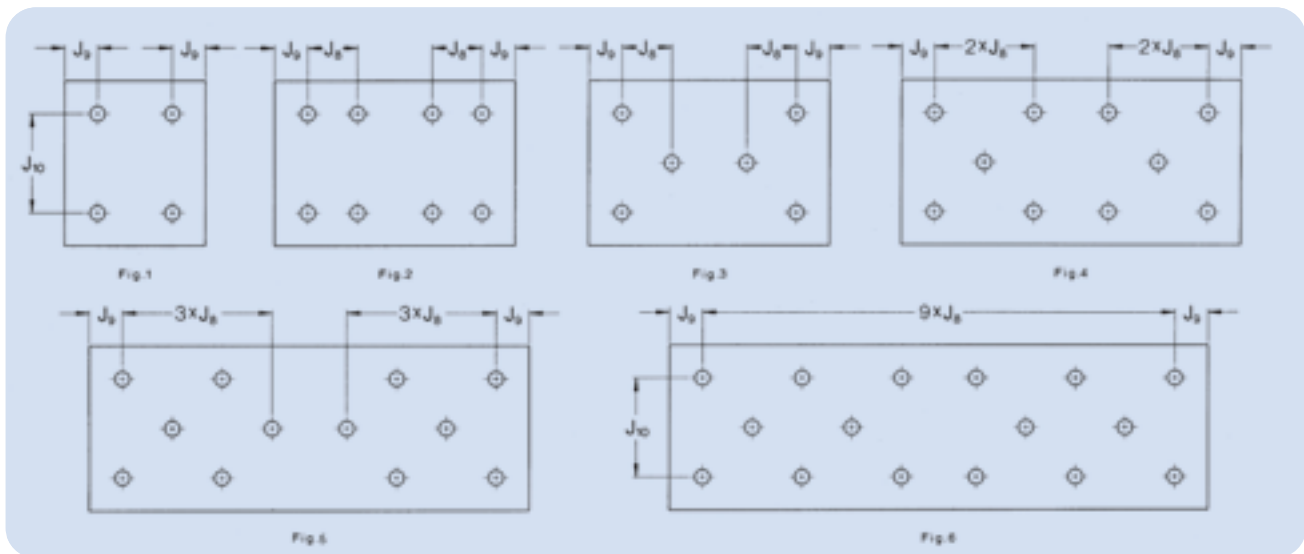

| J_3 | J_4 | J_5 | J_6 | J_7 | J_8 | J_9 | J_{10} | Fig | N | N_1 | T | Load carrying capacity C_{eff} | C_0 | Mass |
|-------|-------|-------|-------|-------|-------|-------|----------|-----|-----|-------|-----|-------------------------------------|-------|------|
| 5,5 | 1x25 | 15 | 39 | 17 | 25 | 10 | 40 | 1 | 4,5 | 8 | 4,6 | 1 030 | 480 | 0,57 |
| 10,5 | 2x25 | | | | | | | 1 | | | | 1 535 | 800 | 0,80 |
| 15,5 | 3x25 | | | | | | | 1 | | | | 1 883 | 1 040 | 1,0 |
| 20,5 | 4x25 | | | | | | | 1 | | | | 2 322 | 1 360 | 1,3 |
| 25,5 | 5x25 | | | | | | | 3 | | | | 2 636 | 1 600 | 1,5 |
| 30,5 | 6x25 | | | | | | | 3 | | | | 3 038 | 1 920 | 1,7 |
| 30,5 | 7x25 | | | | | | | 4 | | | | 3 234 | 2 080 | 2,0 |
| 16 | 1x50 | 30 | 64 | 26 | 50 | 10 | 60 | 1 | 6,6 | 11 | 6,8 | 5 150 | 2 380 | 3,1 |
| 23,5 | 2x50 | | | | | | | 1 | | | | 7 327 | 3 740 | 4,5 |
| 31 | 3x50 | | | | | | | 3 | | | | 8 844 | 4 760 | 5,9 |
| 38,5 | 4x50 | | | | | | | 3 | | | | 10 759 | 6 120 | 7,2 |
| 46 | 5x50 | | | | | | | 3 | | | | 12 134 | 7 140 | 8,6 |
| 56 | 7x50 | | | | | | | 4 | | | | 15 186 | 9 520 | 11,4 |

Notes



Notes

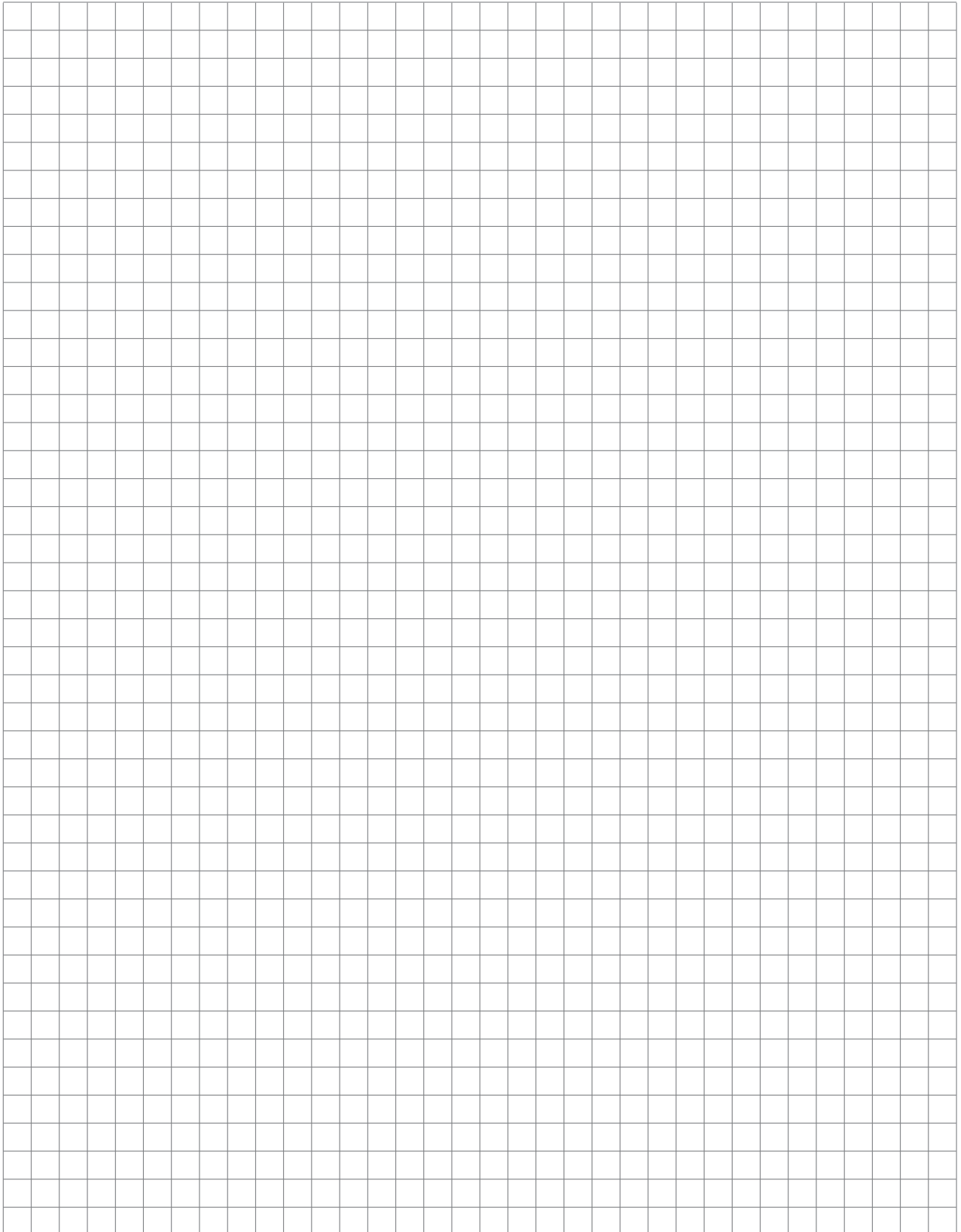



© SKF is a registered trademark of the SKF Group.

© SKF Group 2011

The contents of this publication are the copyright of the publisher and may not be reproduced (even extracts) unless prior written permission is granted. Every care has been taken to ensure the accuracy of the information contained in this publication but no liability can be accepted for any loss or damage whether direct, indirect or consequential arising out of the use of the information contained herein.

PUB 4183/1 EN · April 2011

This publication supersedes publication 4183EN - 0609B

Printed in Sweden on environmentally friendly paper.